

SITE IMPROVEMENTS FOR WASHINGTON ELEMENTARY SCHOOL DISTRICT PALO VERDE MIDDLE SCHOOL 7502 N. 39TH AVENUE, PHOENIX, AZ 85051

GENERAL NOTES

1. THE ENGINEER WILL NOT BE RESPONSIBLE FOR CONSTRUCTION MEANS, METHODS, TECHNIQUES, SEQUENCES OR PROCEDURES OR FOR SAFETY PRECAUTIONS OR PROGRAMS UTILIZED IN CONNECTION WITH THE WORK, AND THE ENGINEER WILL NOT BE RESPONSIBLE FOR THE CONTRACTOR'S FAILURE TO CARRY OUT THE WORK IN ACCORDANCE WITH THE CONTRACT DOCUMENTS.

2. EXISTING UTILITIES SHOWN ON THESE PLANS HAVE BEEN LOCATED ACCORDING TO INFORMATION PROVIDED BY THE AGENCY OPERATING EACH UTILITY. LOCATIONS SHOWN ARE APPROXIMATE ONLY, AND ARE NOT RELIABLE FOR CONSTRUCTION PURPOSES. CALL BLUE STAKE FOR FIELD LOCATION AT (1-800-782 5348).

3. THE DESIGN ENGINEER AND APPLICABLE AGENCY MUST APPROVE, PRIOR TO CONSTRUCTION, ANY ALTERATIONS OR VARIANCE FROM THESE PLANS. ANY VARIATION FROM THESE PLANS SHALL BE PROPOSED ON A CONSTRUCTION FIELD PRINT SET AND TRANSMITTED TO THE ENGINEER.

4. THE CONTRACTOR SHALL PROTECT AND MAINTAIN ALL EXISTING UTILITIES ON THE SITE. ANY DAMAGE TO EXISTING UTILITIES, WHETHER SHOWN OR NOT ON THE PLAN SET SHALL BE REPAIRED AT THE CONTRACTOR'S EXPENSE.

5. INSPECTIONS BY GOVERNMENT AGENCIES, UTILITIES, OR THE ENGINEER, SHALL NOT IN ANY WAY RELIEVE THE CONTRACTOR FROM ANY OBLIGATION TO PERFORM THE WORK IN STRICT COMPLIANCE WITH THE APPLICABLE CODES AND AGENCY REQUIREMENTS.

6. NOTHING CONTAINED IN THE CONTRACT DOCUMENTS SHALL CREATE, NOR SHALL BE CONSTRUED TO CREATE, ANY CONTRACTUAL RELATIONSHIP BETWEEN THE ENGINEER AND THE CONTRACTOR OR ANY SUBCONTRACTOR.

7. IT IS THE SOLE RESPONSIBILITY OF THE CONTRACTOR TO OBTAIN ANY PERMITS REQUIRED AT HIS OWN EXPENSE.

8. THE CONTRACTOR WILL MAKE EXPLORATORY EXCAVATIONS AND LOCATE EXISTING UNDERGROUND FACILITIES SUFFICIENTLY AHEAD OF CONSTRUCTION TO PERMIT THE REVISION OF THESE PLANS IF NECESSARY DUE TO A CONFLICT BETWEEN A FACILITY PROPOSED HEREIN AND AN EXISTING FACILITY.

9. ANY POTENTIAL EXTRA CHARGES BY THE CONTRACTOR WILL BE BROUGHT TO THE ATTENTION OF THE OWNERS, OR THEIR REPRESENTATIVES, PRIOR TO THE OWNER INCURRING THE COST.

10. THE CONTRACTOR AGREES THAT HE, SHALL ASSUME SOLE AND COMPLETE RESPONSIBILITY FOR JOB SITE CONDITIONS DURING THE COURSE OF CONSTRUCTION OF THIS PROJECT, INCLUDING SAFETY OF ALL PERSONS AND PROPERTY, THAT THIS REQUIREMENT SHALL APPLY CONTINUOUSLY AND NOT BE LIMITED TO NORMAL WORKING HOURS, AND THAT THE CONTRACTOR SHALL DEFEND, INDEMNIFY AND HOLD THE OWNER AND THE ENGINEER HARMLESS FROM ANY AND ALL LIABILITY, REAL OR ALLEGED, IN CONNECTION WITH THE PERFORMANCE OF WORK ON THIS PROJECT, EXCEPTING FOR LIABILITY ARISING FROM THE SOLE NEGLIGENCE OF THE OWNER OR ENGINEER.

11. PRIOR TO FINAL APPROVAL AND ACCEPTANCE OF THE WORK THE CONTRACTOR WILL BE REQUIRED TO CLEAN AND REPAIR ADJACENT (OFF-SITE/PROJECT) ROADWAYS USED OR DAMAGED DURING THE COURSE OF CONSTRUCTION.

12. ALL WORK SHALL BE IN ACCORDANCE WITH MARICOPA ASSOCIATION OF GOVERNMENT'S STANDARD SPECIFICATIONS AND DETAILS UNLESS OTHERWISE STATED ON THE PROJECT PLANS OR SPECIFICATIONS. SHOULD THESE DOCUMENTS CONFLICT, THE MORE STRINGENT REQUIREMENT SHALL GOVERN AS DETERMINED BY THE ENGINEER.

13. THE CONTRACTOR IS RESPONSIBLE FOR PROVIDING ADEQUATE DRAINAGE AND EROSION & SEDIMENT CONTROL ON THE CONSTRUCTION SITE PER CITY, FEDERAL, STATE AND COUNTY REQUIREMENTS AND MAINTAINED FOR THE WHOLE DURATION OF THE PROJECT.

14. THE CONTRACTOR SHALL BE RESPONSIBLE FOR ALL SHORING AND RETAINING SYSTEMS. SYSTEMS SHALL BE DESIGNED AND SEALED BY A LICENSED STRUCTURAL ENGINEER, WHO IS REGISTERED IN THE STATE OF ARIZONA. ALL DESIGNS SHALL BE SUBMITTED TO THE CITY FOR REVIEW AND APPROVED PRIOR TO INSTALLATION.

15. ALL QUANTITIES PROVIDE ON THE PLANS AND BID ITEM LIST ARE FOR ENGINEERING PURPOSES ONLY. CONTRACTOR IS RESPONSIBLE FOR THEIR OWN QUANTITIES AND SHALL NOTIFY PRIOR TO BID ANY DISCREPANCIES TO THE ENGINEER.

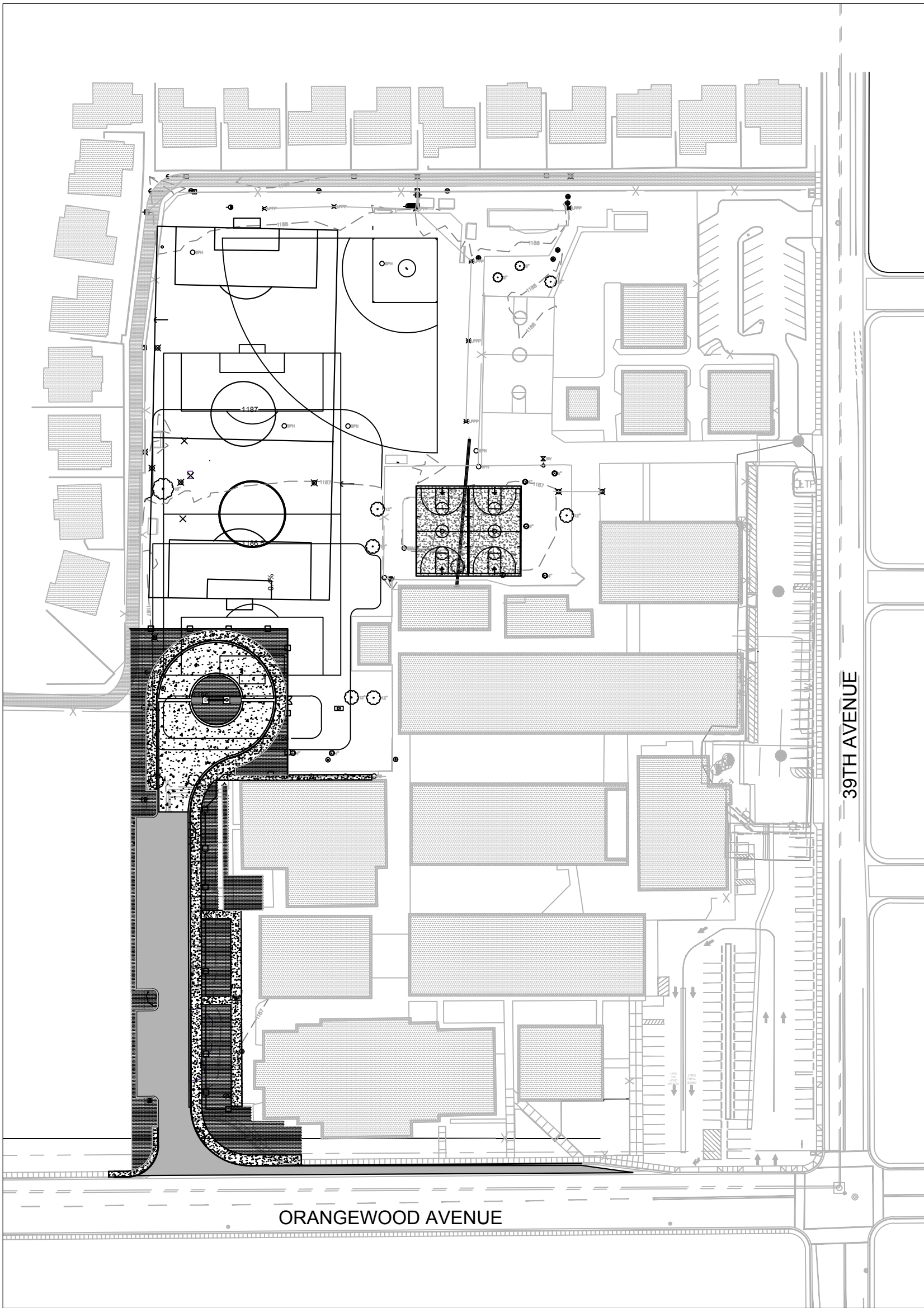

LOCATION MAP

1" = 100' SCALE



OWNER/DEVELOPER:
WASHINGTON ELEMENTARY
SCHOOL DISTRICT
4650 WEST SWEETWATER AVE.
GLENDALE, ARIZONA 85304
CONTACT: MIKE KRAMER
PHONE: (602) 347-4835
FAX: (602) 347-4836

ENGINEER:
KIMLEY-HORN
7740 N. 16TH ST, STE 300
PHOENIX, ARIZONA 85020
CONTACT: SEAN WOZNY
PHONE: (602) 906-1107
FAX: (602) 944-7423

GENERAL NOTES:

A. ACCESS TO CONSTRUCTION SHALL BE RESTRICTED FOR $\frac{1}{2}$ HOURS BEFORE AND $\frac{1}{2}$ HOURS AFTER SCHOOL ARRIVAL AND RELEASE TIMES. VERIFY TIMES WITH WESD PRIOR TO CONSTRUCTION

B. CONSTRUCTION SITE MUST BE FENCED OFF AT ALL TIMES. ANY WORK REQUIRED OUTSIDE OF THE MAIN CONSTRUCTION AREA SUCH AS NEW FENCING AND SIDEWALKS SHALL BE COORDINATED WITH WESD FOR SAFETY CONCERNS.

C. ALL CAMPUS BUILDINGS TO REMAIN IN OPERATION DURING CONSTRUCTION, COORDINATE WITH DISTRICT FOR ALL REQUIRED UTILITY SHUT-OFFS, ETC.

D. PROVIDE PROTECTIVE MESH ON CONSTRUCTION FENCING ADJACENT TO PLAY AREAS. CONSTRUCTION FENCING & STAGING MUST BE APPROVED BY DISTRICT BEFORE COMMENTING WORK.

E. VERIFY ALL EXISTING CONDITIONS BEFORE COMMENCING WORK.

F. CONTRACTOR TO VERIFY ALL UTILITY LOCATIONS, ONSITE AND OFFSITE, PRIOR TO COMMENCEMENT OF WORK. CONTRACTOR TO UTILIZE A PRIVATE UTILITY LOCATOR TO LOCATE ONSITE UTILITIES.

UNDERGROUND UTILITY NOTES

1. A REASONABLE ATTEMPT HAS BEEN MADE TO SHOW THE LOCATIONS OF ALL UNDERGROUND OBSTRUCTIONS AND UTILITY LINES IN THE WORK AREA. HOWEVER, THE CONTRACTOR SHALL BE RESPONSIBLE FOR ANY DAMAGE TO OBSTRUCTIONS AND UTILITY LINES ENCOUNTERED DURING CONSTRUCTION AND SHALL DETERMINE THE EXACT LOCATION OF UTILITIES AND MAKE THE ENGINEER AWARE, IN ADVANCE OF CONSTRUCTION.

2. THE CONTRACTOR SHALL FIELD-VERIFY THE HORIZONTAL AND VERTICAL LOCATIONS OF ALL EXISTING UTILITIES PRIOR TO CONSTRUCTION. THE CONTRACTOR SHALL IMMEDIATELY NOTIFY THE ENGINEER IF ACTUAL LOCATIONS DIFFER FROM THOSE SHOWN ON THE PLANS.

3. NOTHING CONTAINED IN THE CONTRACT DOCUMENTS SHALL CREATE, NOR SHALL BE CONSTRUED TO CREATE ANY CONTRACTUAL RELATIONSHIP BETWEEN THE ENGINEER AND THE CONTRACTOR OR SUBCONTRACTOR.

4. THE ENGINEER WILL NOT BE RESPONSIBLE FOR CONSTRUCTION MEANS, METHODS, TECHNIQUES, SEQUENCES, OR PROCEDURES OR FOR SAFETY PRECAUTIONS OR PROGRAMS, UTILIZED IN CONNECTION WITH THE WORK, AND WILL NOT BE RESPONSIBLE FOR THE CONTRACTOR'S FAILURE TO CARRY OUT THE WORK IN ACCORDANCE WITH THE CONTRACT DOCUMENTS.

UTILITY CONFLICT REVIEW:

COMPANY	UTILITY	CONTACT	PHONE	EMERGENCY PHONE	DATE
APS	ELECTRIC	JOLIE BUROW	602 493 4225	602 371 7171	11-08-2023
CITY OF PHOENIX WATER SERVICES DEPARTMENT	RECLAIMED WATER SANITARY SEWER WATER	RUBEN ESTRELLA	602 534 6979	602 262 8280	11-08-2023
COX	CATV, FIBER OPTIC	GWENDALYN GARCIA	623 328 4073	623 322 7278	11-08-2023
CENTURY LINK	COAXIAL, FIBER OPTIC	ELM LOCATING	623 780 3350	800 283 4237	11-08-2023
SOUTHWEST GAS	NATURAL GAS	RIC TORRES	602 763 4542	602 271 4277	11-08-2023
HONEYWELL, INC	WATER	ALEX HEIRMAN	602 942 9691	602 942 9691	11-08-2023
CITY OF PHOENIX TRAFFIC SIGNALS	FIBER, JUNCTION BOX, TRAFFIC SIGNALS	MAIN DESK	602 262 6204	602 262 6021	11-08-2023

BLUE STAKE
CONTRACTOR TO CALL BLUE STAKE PRIOR TO STARTING CONSTRUCTION ACTIVITY.

LEGEND

$\times 1247.45$	EXISTING SPOT ELEVATION	RIM	RIM ELEVATION	SECTION LINE		
-XXXX-	EXISTING CONTOUR	INV.	INVERT ELEVATION	CENTER LINE		ELECTRIC BOX
XXXX-	EXISTING INDEX CONTOUR	TC	TOP OF CURB ELEVATION	BOUNDARY LINE		LIGHT
-XXXX-	PROPOSED CONTOUR	P	PAVEMENT ELEVATION	RIGHT-OF-WAY LINE		CABLE BOX
-XXXX-	PROPOSED INDEX CONTOUR	G	GUTTER	BRASS CAP IN HANDHOLE (UNO)		CABLE VAULT
-XXXX-	PROPOSED INDEX CONTOUR	SW	SIDEWALK	BRASS CAP FLUSH (UNO)		
$\frac{1.0\%}{\text{arrow}}$	SLOPE	GB	GRADE BREAK	FOUND 1/2" REBAR (UNO)		
	DIRECTION OF FLOW	FF	FINISH FLOOR ELEVATION	PROPERTY CORNER (NOT SET)		GAS MARKER SIGN
	DRYWELL	SC	SCUPPER INVERT ELEVATION	FIRE HYDRANT		
	EXISTING UTILITY BOX	FL	FLOWLINE	WATER VALVE		
	EXISTING LIGHT POLE	E	EXISTING	WATER METER		
	EXISTING FENCE	GRD	EXISTING GROUND ELEVATION	BLOW OFF VALVE		
SW=XXXX.XX	RIGHT-OF-WAY LINE	TW	TOP OF WALL	SANITARY SEWER MANHOLE		
-x-	PROPOSED FENCE	BW	BOTTOM OF WALL	SANITARY SEWER CLEANOUT		
				GRADE BREAK		

AS-BUILT CERTIFICATION

I HEREBY CERTIFY THAT THE "RECORD DRAWING" MEASUREMENTS AS SHOWN HEREON WERE MADE UNDER MY SUPERVISION OR AS NOTED AND ARE CORRECT TO THE BEST OF MY KNOWLEDGE AND BELIEF.

REGISTERED LAND SURVEYOR _____ DATE _____

REGISTRATION NUMBER _____

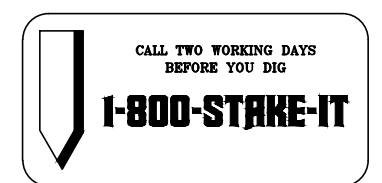
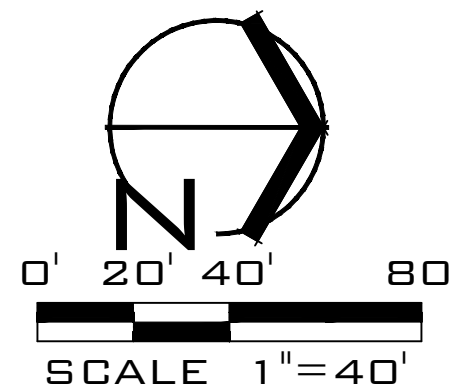
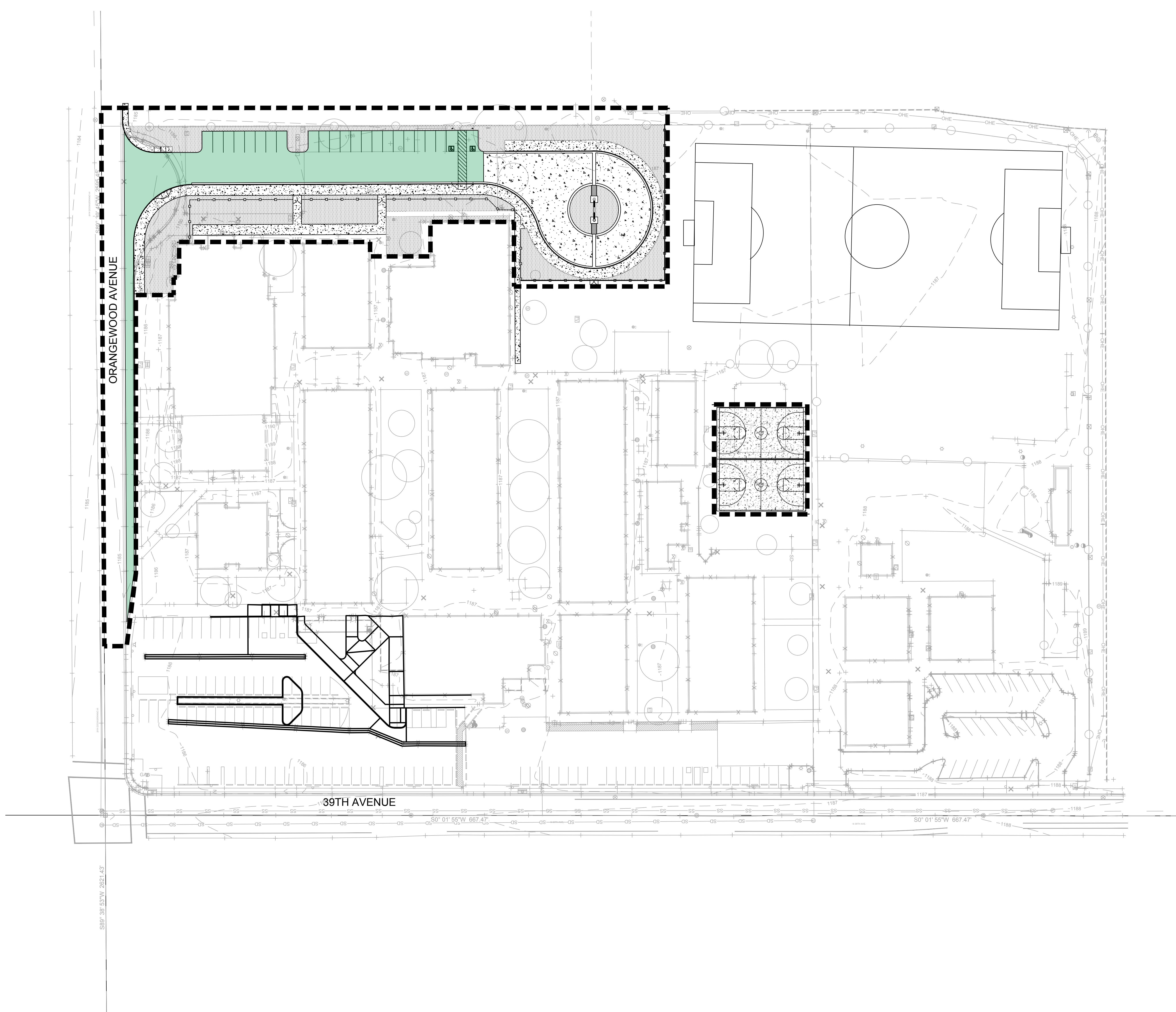

DRAWN BY: SRW
JOB NO: 2138.300
DATE: 11/16/23
REVISIONS

SITE PLAN
C1.1
100% SCHEMATIC DESIGN

**WESD - PALO VERDE MS
SITE IMPROVEMENTS**
7502 N. 39th Avenue
Phoenix, AZ 85051

CONSULTANTS
CIVIL
Kimley-Horn
7740 N 16th St, Suite 300
Phoenix, AZ 85020
Phone: 602.944.5500

ELECTRICAL
Energy Systems Design, Inc
7135 E Camelback Rd.
Suite 275
Scottsdale, AZ 85251
Phone: 480.481.4900

bws **ARCHITECTS**
BURNS WALD-HOPKINS SHAMBACH ARCHITECTS
261 North Court Avenue
Tucson, Arizona 85701
520.793.2705
www.bwsarchitects.com

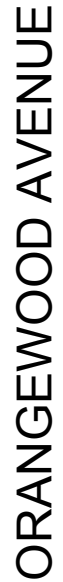

WE COULD HAVE

S89° 39' 45"W 2595.45'

- ① Contractor to remove and properly dispose of existing concrete, limits as per plan.
- ② Contractor to remove and properly dispose of existing asphalt pavement, limits as per plan.
- ③ Contractor to remove and properly dispose of existing turf, limits as per plan. Adjust irrigation as needed.
- ④ Contractor to remove existing tree, complete.
- ⑤ Contractor to sawcut and remove existing concrete curb and gutter, complete.
- ⑥ Contractor to remove existing concrete curb, complete.
- ⑦ Contractor to remove existing sand, complete.

- ① Existing fire hydrant, contractor to protect in place, typ.
- ② Existing fire line backflow preventor, contractor to protect in place, typ.
- ③ Existing irrigation backflow preventor, contractor to protect in place, typ.
- ④ Existing electrical service, contractor to protect in place, typ.

NOTE:
CONTRACTOR TO DOWEL CONNECT
ALL NEW CONCRETE TO EXISTING
CONCRETE AS PER DETAILS.

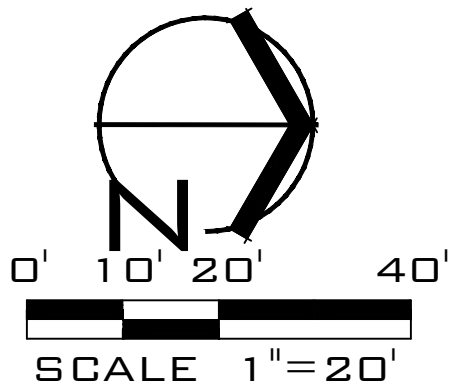

CONSULTANTS

CIVIL

Kimley-Horn
7740 N 16th St, Suite 300
Phoenix, AZ 85020
Phone: 602.944.5500

ELECTRICAL

Energy Systems Design,

7135 E. C.

Suite 275

Scottsdale, AZ 85251

WESD - PALO VERDE MS SITE IMPROVEMENTS

7502 N. 39th Avenue
Phoenix, AZ 85051

DEMOLITION PLAN

C1.2

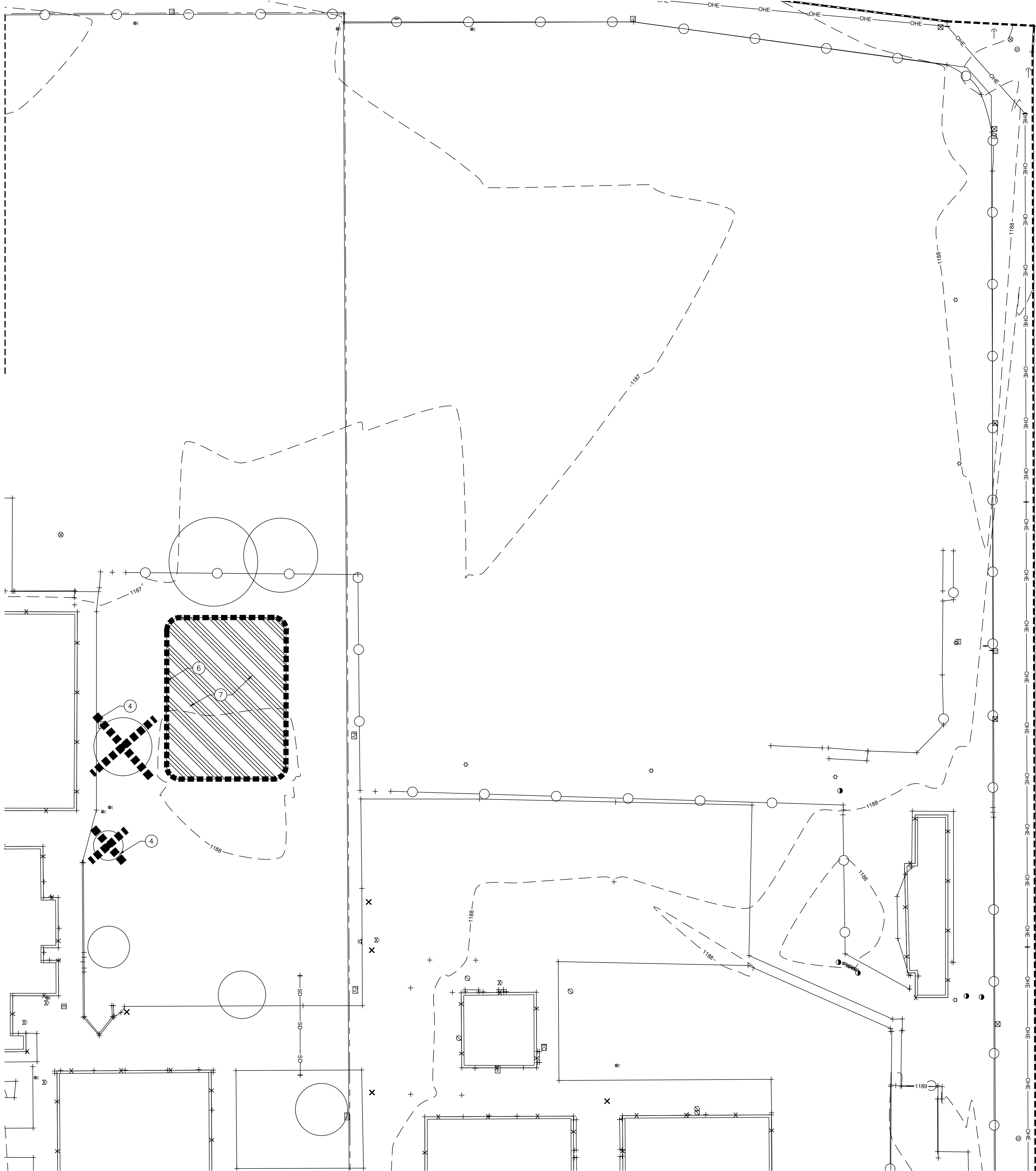

KEY NOTES

- Contractor to remove and properly dispose of existing concrete, limits as per plan.
- Contractor to remove and properly dispose of existing asphalt pavement, limits as per plan.
- Contractor to remove and properly dispose of existing turf, limits as per plan. Adjust irrigation as needed.
- Contractor to remove existing tree, complete.
- Contractor to sawcut and remove existing concrete curb and gutter, complete.
- Contractor to remove existing concrete curb, complete.
- Contractor to remove existing sand, complete.

bws ARCHITECTS

BURNS WALD-HOPKINS SHAMBACH ARCHITECTS
261 North Court Avenue
Tucson, Arizona 85701
520.793.2705
www.bwsarchitects.com

CONSULTANTS

CIVIL
Kimley-Horn
7740 N 16th St, Suite 300
Phoenix, AZ 85020
Phone: 602.944.5500

ELECTRICAL
Energy Systems Design, Inc
7135 E Camelback Rd.
Suite 275
Scottsdale, AZ 85251
Phone: 480.481.4900

WESD - PALO VERDE MS
SITE IMPROVEMENTS

7502 N. 39th Avenue
Phoenix, AZ 85051

DRAWN BY: SRW
JOB NO: 2138.300
DATE: 11/16/23
REVISIONS

DEMOLITION PLAN

C1.3
100% SCHEMATIC DESIGN

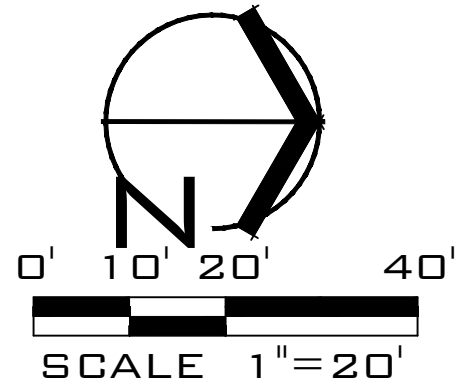

NOTE:
CONTRACTOR TO DOWEL CONNECT
ALL NEW CONCRETE TO EXISTING
CONCRETE AS PER DETAILS.



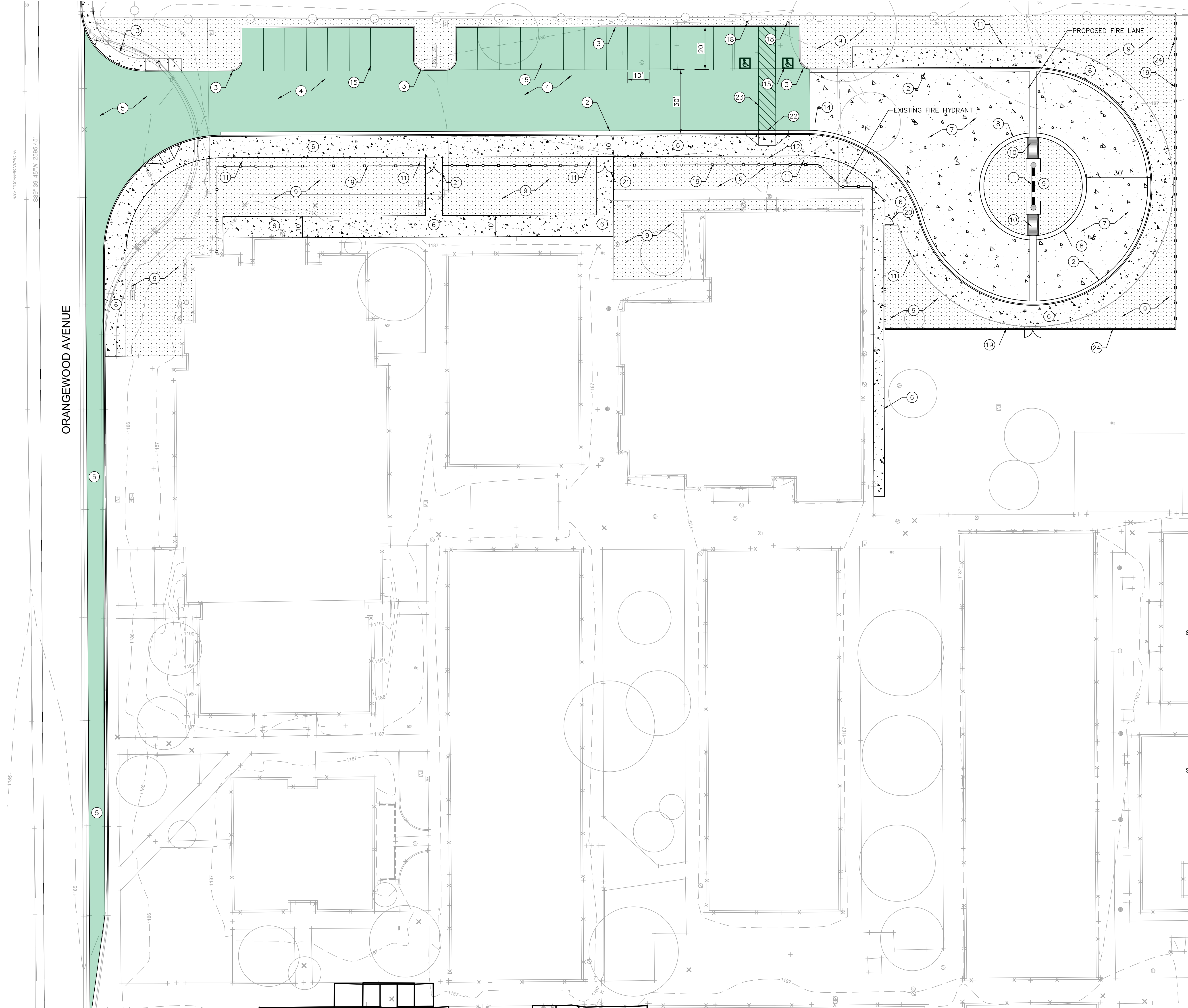

- PROJECT KEY NOTES**
- 1 INSTALL MAXWELL IV DUAL CHAMBER DRY WELL
 - 2 CONSTRUCT 6" VERTICAL CONCRETE CURB & GUTTER AS PER MAG STD. DTL. 220-1 'A'.
 - 3 CONSTRUCT 6" VERTICAL CONCRETE SINGLE CURB AS PER MAG STD. DTL. 222 'A'.
 - 4 NEW ASPHALT PAVEMENT 3" AC PAVEMENT OVER 8" ABC ON 8" PREPARED SUB-GRADE AS PER MAG SPECIFICATION SECTIONS 321 & 710.
 - 5 NEW ASPHALT PAVEMENT 5" AC PAVEMENT OVER 8" ABC ON 10" PREPARED SUB-GRADE AS PER MAG SPECIFICATION SECTIONS 321 & 710.
 - 6 CONSTRUCT CONCRETE SIDEWALK AS PER COP STD. DTL. P1230, 4" THICK, 3,000 PSI, DOWEL CONNECT TO EXISTING SIDEWALK ON ALL EXISTING EDGES.
 - 7 CONSTRUCT CONCRETE DRIVE WITH MAG CLASS 'AA', 4,000 PSI 8" CONCRETE PAVEMENT WITH STEEL REINFORCEMENT AND JOINTING PER DETAILS OVER 8" PREPARED SUB-GRADE AS PER MAG SPECIFICATIONS SECTION 301. CONCRETE PAVEMENT AS PER MAG SPECIFICATION SECTION 324. DOWEL CONNECT TO EXISTING BUILDINGS.
 - 8 CONSTRUCT VERTICAL CONCRETE ROLL CURB WITH GUTTER AS PER MAG STD. DTL. 220-1 'C'.
 - 9 INSTALL ¾ MINUS DECOMPOSED GRANITE, MADISON GOLD.
 - 10 CONSTRUCT CONCRETE SCUPPER PAN AS PER MAG STD. DTL. 206, MODIFIED. DOWEL CONNECT TO CONCRETE CURB, TYP.
 - 11 CONTRACTOR TO INSTALL BUSES ONLY SIGN (34"x30") WITH NEW POLE & CONC. FOUNDATION AS PER MAG STD DTL 131, TYPE 'B'.
 - 12 CONTRACTOR TO INSTALL SCHOOL CROSSING PER MUTCD S1-1 WITH NEW SIGN POLE AND CONC. FOUNDATION AS PER MAG STD DTL 131, TYPE 'B'. FACE OF SIGN SHALL BE LOCATED 2 FT FROM THE BACK OF CURB OR EDGE OF SIDEWALK.
 - 13 CONTRACTOR TO INSTALL 'STOP' SIGN PER MUTCD R3-5-R WITH NEW POLE & CONC. FOUNDATION PER MAG STD DTL131, TYPE 'B'.
 - 14 INSTALL CATCH BASIN AS PER MAG STD. DTL 535, TYPE 'F'.
 - 15 PAINT NEW PARKING STALL STRIPING 4-IN WIDTH (WHITE), 9 FT O.C. AS PER C.O.P. DETAIL, TYP.
 - 16 PAINT 24" STOP BAR MARKINGS, (WHITE)
 - 17 PAINT FIRE LANE CURB LINE, (RED)
 - 18 INSTALL ADA PARKING SIGNING AND STRIPING AS PER DETAILS, TYP.
 - 19 INSTALL 6 FT, HEIGHT, WROUGHT IRON FENCE, SUBMIT SHOP DRAWINGS FOR APPROVAL. MATCH EXISTING TYPE AND POWER COAT PAINT.
 - 20 INSTALL 6 FT, HEIGHT, 4 FT WIDE WROUGHT IRON GATE WITH LOCK EQUIPMENT, TYP. SUBMIT SHOP DRAWINGS FOR APPROVAL. MATCH EXISTING TYPE AND POWER COAT PAINT.
 - 21 INSTALL 6 FT, HEIGHT, 4 FT WIDE WROUGHT IRON DOUBLE GATES (8 FT TOTAL OPENING) WITH LOCK EQUIPMENT, TYP. SUBMIT SHOP DRAWINGS FOR APPROVAL. MATCH EXISTING TYPE AND POWER COAT PAINT.
 - 22 INSTALL CONCRETE RAMP AS PER MAG STD DTL. 238-3, WITH TRUNCATED DOMES.
 - 23 INSTALL NEW PAINTED CROSSWALK YELLOW.
 - 24 INSTALL CONCRETE HEADER CURB AS PER DETAILS.
 - 25 INSTALL CONCRETE BASKETBALL COURT AS PER DETAILS

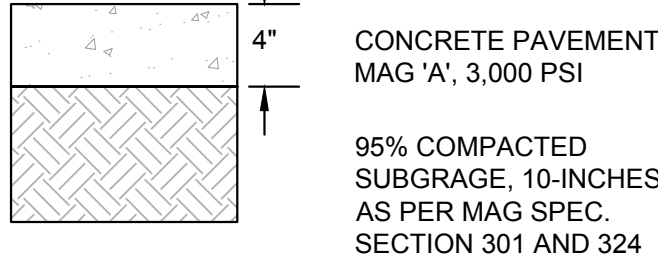

1 CONCRETE SIDEWALK SECTION
SCALE: N.T.S.

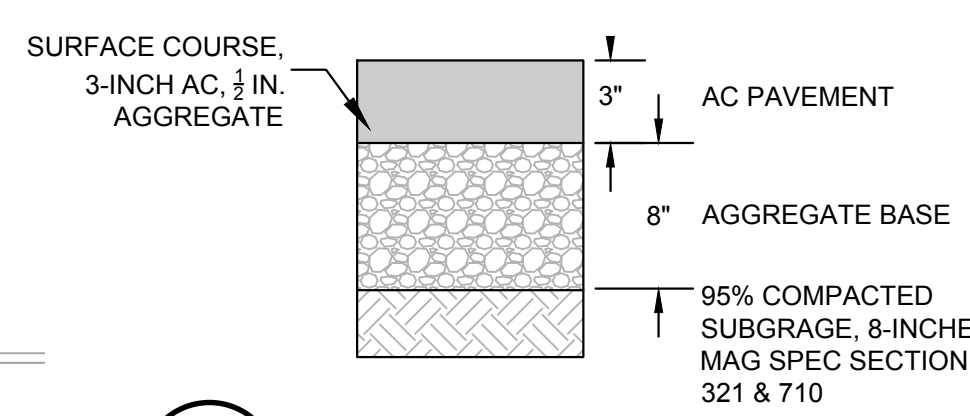

2 ASPHALT PAVEMENT SECTION PARKING AREA
SCALE: N.T.S.

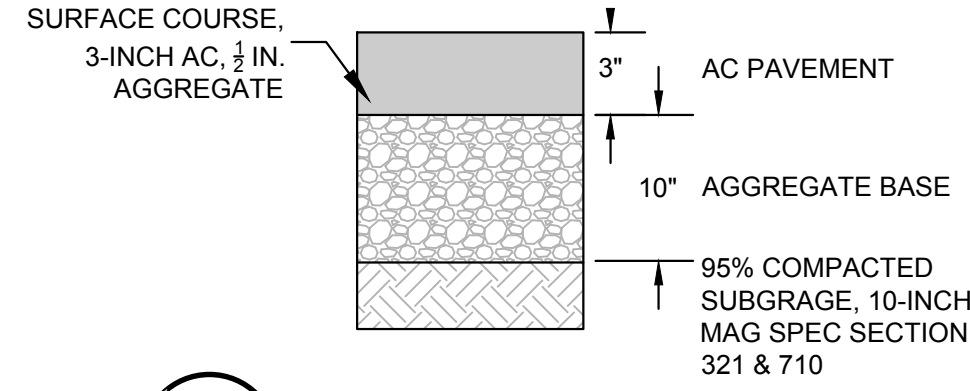

3 ASPHALT PAVEMENT SECTION PARKING AREA
SCALE: N.T.S.

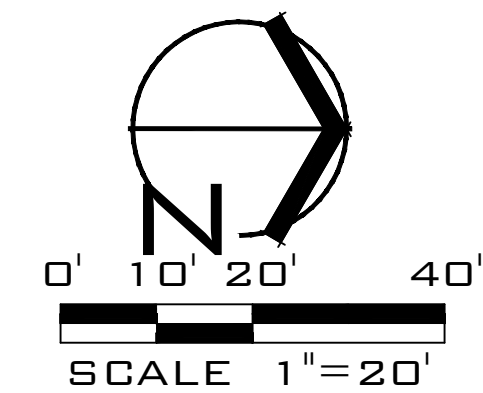

NOTE:
CONTRACTOR TO DOWEL CONNECT ALL NEW CONCRETE TO EXISTING CONCRETE AS PER DETAILS.

CONSULTANTS
CIVIL
Kimley-Horn
7740 N 16th St, Suite 300
Phoenix, AZ 85020
Phone: 602.944.5500

ELECTRICAL
Energy Systems Design, Inc
7135 E Camelback Rd.
Suite 275
Scottsdale, AZ 85251
Phone: 480.481.4900

**WESD - PALO VERDE MS
SITE IMPROVEMENTS**
7502 N. 39th Avenue
Phoenix, AZ 85051

DRAWN BY: SRW
JOB NO: 2138.300
DATE: 11/16/23
REVISIONS

COVER SHEET

C1.4
100% SCHEMATIC DESIGN

bws ARCHITECTS
BURNS WALD-HOPKINS SHAMBACH ARCHITECTS
261 North Court Avenue
Tucson, Arizona 85701
520.793.2705
www.bwsarchitects.com

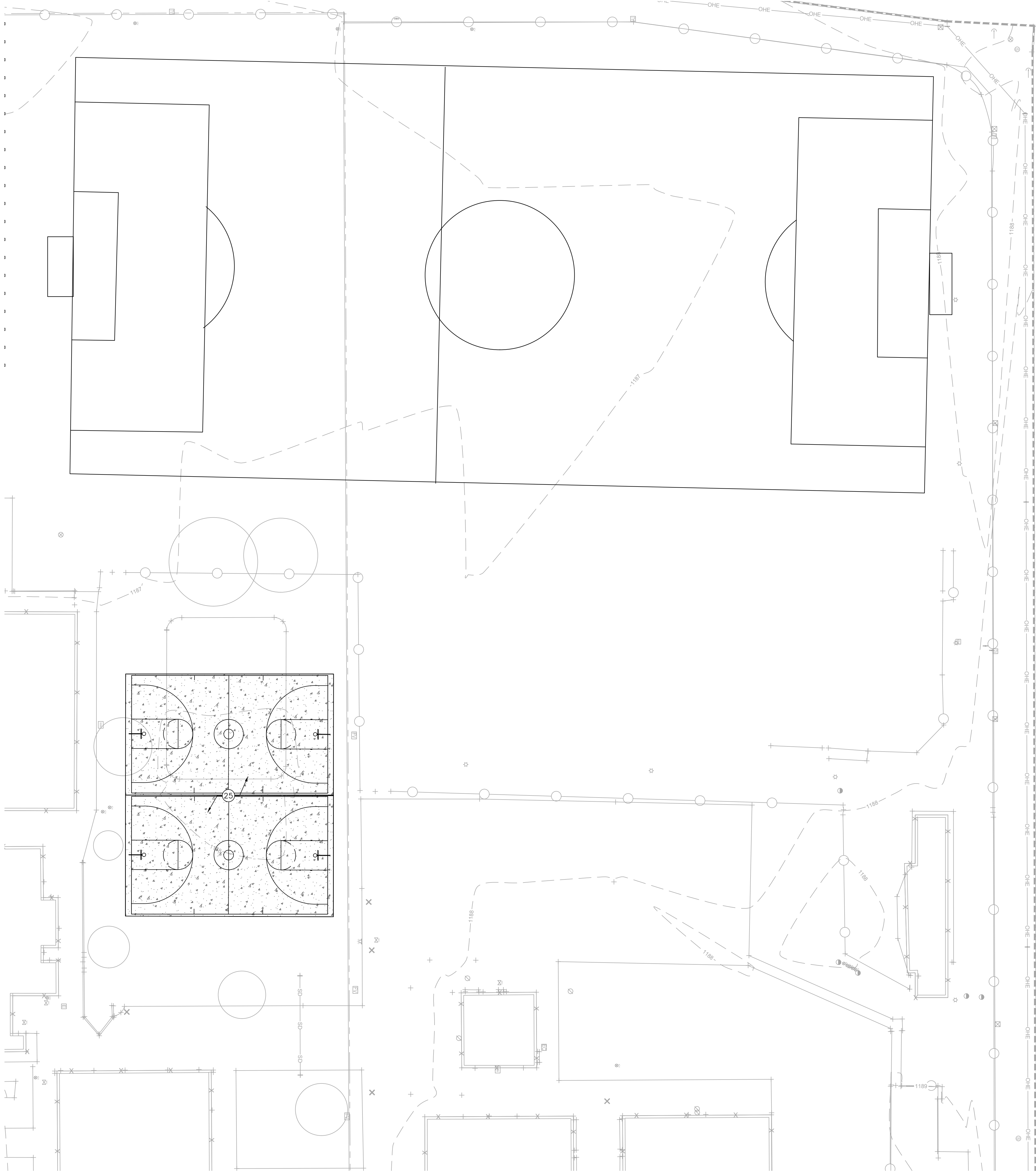

PROJECT KEY NOTES

- 1 INSTALL MAXWELL IV DUAL CHAMBER DRY WELL
- 2 CONSTRUCT 6" VERTICAL CONCRETE CURB & GUTTER AS PER MAG STD. DTL. 220-1 'A'.
- 3 CONSTRUCT 6" VERTICAL CONCRETE SINGLE CURB AS PER MAG STD. DTL. 222 'A'.
- 4 NEW ASPHALT PAVEMENT 3" AC PAVEMENT OVER 8" ABC ON 8" PREPARED SUB-GRADE AS PER MAG SPECIFICATION SECTIONS 321 & 710.
- 5 NEW ASPHALT PAVEMENT 5" AC PAVEMENT OVER 8" ABC ON 10" PREPARED SUB-GRADE AS PER MAG SPECIFICATION SECTIONS 321 & 710.
- 6 CONSTRUCT CONCRETE SIDEWALK AS PER COP STD. DTL. P1230, 4" THICK, 3,000 PSI, DOWEL CONNECT TO EXISTING SIDEWALK ON ALL EXISTING EDGES.
- 7 CONSTRUCT CONCRETE DRIVE WITH MAG CLASS 'AA', 4,000 PSI 8" CONCRETE PAVEMENT WITH STEEL REINFORCEMENT AND JOINTING PER DETAILS OVER 8" PREPARED SUB-GRADE AS PER MAG SPECIFICATIONS SECTION 301. CONCRETE PAVEMENT AS PER MAG SPECIFICATION SECTION 324. DOWEL CONNECT TO EXISTING BUILDINGS.
- 8 CONSTRUCT VERTICAL CONCRETE ROLL CURB WITH GUTTER AS PER MAG STD. DTL. 220-1 'C'.
- 9 INSTALL ¾ MINUS DECOMPOSED GRANITE, MADISON GOLD.
- 10 CONSTRUCT CONCRETE SCUPPER PAN AS PER MAG STD. DTL. 206, MODIFIED. DOWEL CONNECT TO CONCRETE CURB, TYP.
- 11 CONTRACTOR TO INSTALL BUSES ONLY SIGN (34"x30") WITH NEW POLE & CONC. FOUNDATION AS PER MAG STD DTL. 131, TYPE 'B'.
- 12 CONTRACTOR TO INSTALL SCHOOL CROSSING PER MUTCD S1-1 WITH NEW SIGN POLE AND CONC. FOUNDATION AS PER MAG STD DTL. 131, TYPE 'B'. FACE OF SIGN SHALL BE LOCATED 2 FT FROM THE BACK OF CURB OR EDGE OF SIDEWALK.
- 13 CONTRACTOR TO INSTALL 'STOP' SIGN PER MUTCD R3-5-R WITH NEW POLE & CONC. FOUNDATION PER MAG STD DTL.131, TYPE 'B'.
- 14 INSTALL ANGULAR RIP RAP, D50=6, AT 18-INCH DEPTH WITH CONCRETE HEADER CURB AROUND PERIMETER OF RIP RAP.
- 15 PAINT NEW PARKING STALL STRIPING 4-IN WIDTH (WHITE), 9 FT O.C. AS PER C.O.P. DETAIL, TYP.
- 16 PAINT 24" STOP BAR MARKINGS. (WHITE)
- 17 PAINT FIRE LANE CURB LINE. (RED)
- 18 INSTALL ADA PARKING SIGNING AND STRIPING AS PER DETAILS, TYP.
- 19 INSTALL 6 FT. HEIGHT, WROUGHT IRON FENCE, SUBMIT SHOP DRAWINGS FOR APPROVAL. MATCH EXISTING TYPE AND POWER COAT PAINT.
- 20 INSTALL 6 FT. HEIGHT, 4 FT WIDE WROUGHT IRON GATE WITH LOCK EQUIPMENT, TYP. SUBMIT SHOP DRAWINGS FOR APPROVAL. MATCH EXISTING TYPE AND POWER COAT PAINT.
- 21 INSTALL 6 FT. HEIGHT, 4 FT WIDE WROUGHT IRON DOUBLE GATES (8 FT TOTAL OPENING) WITH LOCK EQUIPMENT, TYP. SUBMIT SHOP DRAWINGS FOR APPROVAL. MATCH EXISTING TYPE AND POWER COAT PAINT.
- 22 INSTALL CONCRETE RAMP AS PER MAG STD DTL. 238-3, WITH TRUNCATED DOMES.
- 23 INSTALL NEW PAINTED CROSSWALK YELLOW.
- 24 INSTALL CONCRETE HEADER CURB AS PER DETAILS.
- 25 INSTALL CONCRETE BASKETBALL COURT AS PER DETAILS

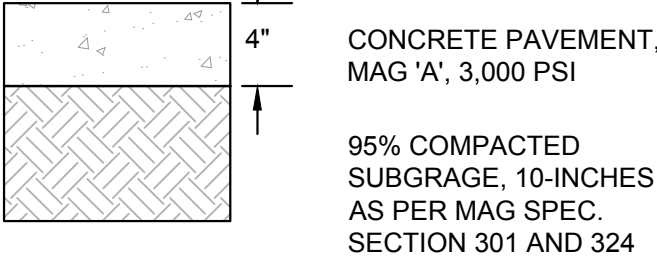

1 CONCRETE SIDEWALK SECTION
SCALE: N.T.S.

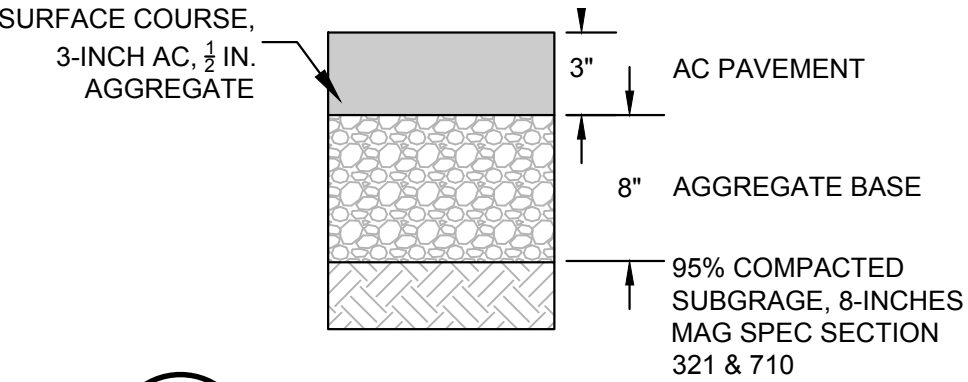

2 ASPHALT PAVEMENT SECTION
PARKING AREA
SCALE: N.T.S.

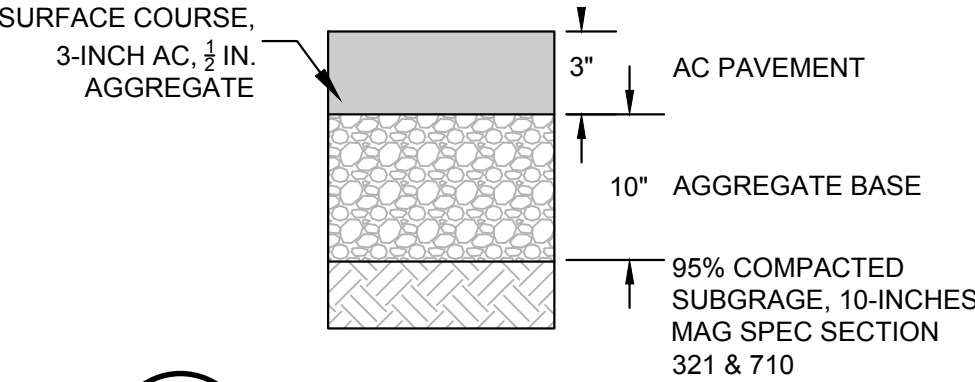

3 ASPHALT PAVEMENT SECTION
PARKING AREA
SCALE: N.T.S.

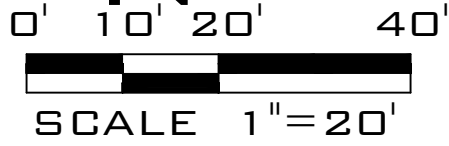

NOTE:
CONTRACTOR TO DOWEL CONNECT
ALL NEW CONCRETE TO EXISTING
CONCRETE AS PER DETAILS.

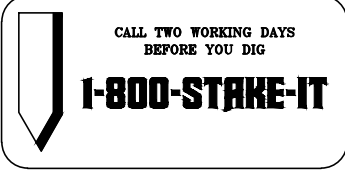

CONSULTANTS

CIVIL
Kimley-Horn
7740 N 16th St, Suite 300
Phoenix, AZ 85020
Phone: 602.944.5500

ELECTRICAL
Energy Systems Design, Inc
7135 E Camelback Rd.
Suite 275
Scottsdale, AZ 85251
Phone: 480.481.4900

**WESD - PALO VERDE MS
SITE IMPROVEMENTS**

7502 N. 39th Avenue
Phoenix, AZ 85051

DRAWN BY: SRW
JOB NO: 2138.300
DATE: 11/16/23
REVISIONS

COVER SHEET

C1.5
100% SCHEMATIC DESIGN

bws ARCHITECTS

BURNS WALD-HOPKINS SHAMBACH ARCHITECTS
261 North Court Avenue
Tucson, Arizona 85701
520.793.2705
www.bwsarchitects.com



KEY NOTES

- Contractor to install Maxwell Plus dual chamber drywell as per detail no. 1 on sheet GD2.1 with concrete pads around drywell covers/grates (8ft x 8ft x 6" thick), MAG 'A', 3,000 psi. as per details.
- Contractor to install catch basin as per MAG std. dtl. 535 type 'F'.
- Contractor to install 12-inch diameter HDPE storm drain pipe with all necessary fittings. Trench and backfill as per MAG std. specification section 601 with installation as per MAG std. specification 618.

CONSULTANTS

CIVIL
Kimley-Horn
7740 N 16th St, Suite 300
Phoenix, AZ 85020
Phone: 602.944.5500

ELECTRICAL
Energy Systems Design, Inc
7135 E Camelback Rd.
Suite 275
Scottsdale, AZ 85251
Phone: 480.481.4900

**WESD - PALO VERDE MS
SITE IMPROVEMENTS**

7502 N. 39th Avenue
Phoenix, AZ 85051

**GRADING & DRAINAGE
PLAN**

C1.6
100% SCHEMATIC DESIGN

DRAWN BY: SRW
JOB NO: 2138.300
DATE: 11/16/23
REVISIONS

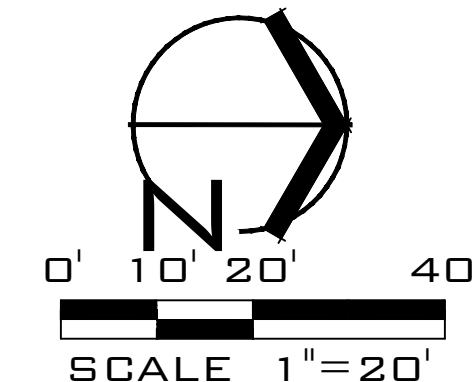

NOTE:
CONTRACTOR TO DOWEL CONNECT
ALL NEW CONCRETE TO EXISTING
CONCRETE AS PER DETAILS.



bws ARCHITECTS

BURNS WALD-HOPKINS SHAMBACH ARCHITECTS
261 North Court Avenue
Tucson, Arizona 85701
520.793.2705
www.bwsarchitects.com

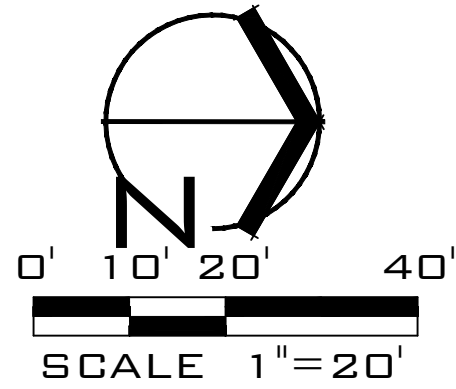
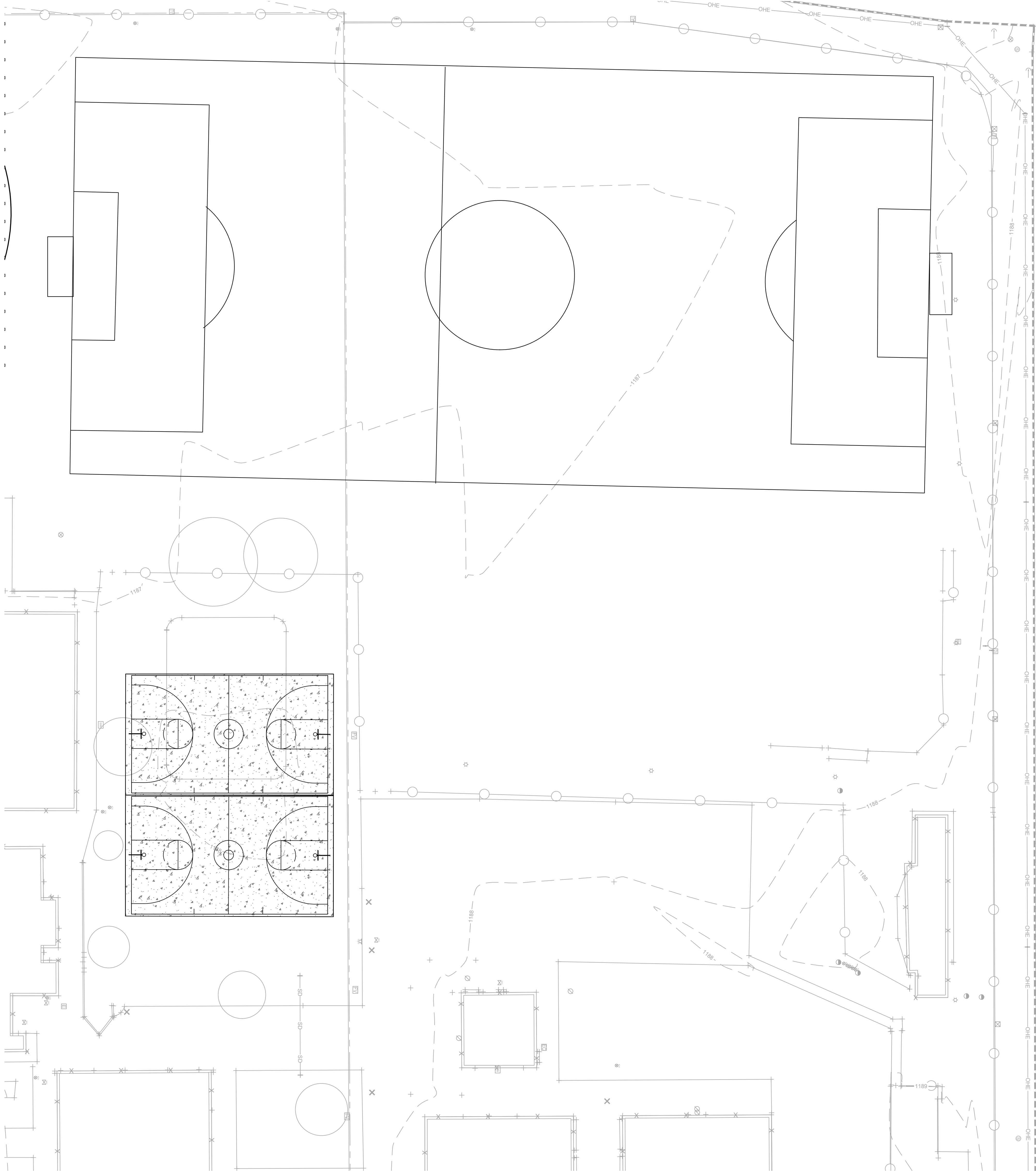

NOTE:
CONTRACTOR TO DOWEL CONNECT
ALL NEW CONCRETE TO EXISTING
CONCRETE AS PER DETAILS.



GRADING & DRAINAGE
PLAN

C1.7
100% SCHEMATIC DESIGN

CONSULTANTS

CIVIL
Kimley-Horn
7740 N 16th St, Suite 300
Phoenix, AZ 85020
Phone: 602.944.5500

ELECTRICAL
Energy Systems Design, Inc
7135 E Camelback Rd.
Suite 275
Scottsdale, AZ 85251
Phone: 480.481.4900

**WESD - PALO VERDE MS
SITE IMPROVEMENTS**

7502 N. 39th Avenue
Phoenix, AZ 85051

DRAWN BY: SRW
JOB NO: 2138.300
DATE: 11/16/23
REVISIONS

bws ARCHITECTS

BURNS WALD-HOPKINS SHAMBACH ARCHITECTS
261 North Court Avenue
Tucson, Arizona 85701
520.793.2705
www.bwsarchitects.com

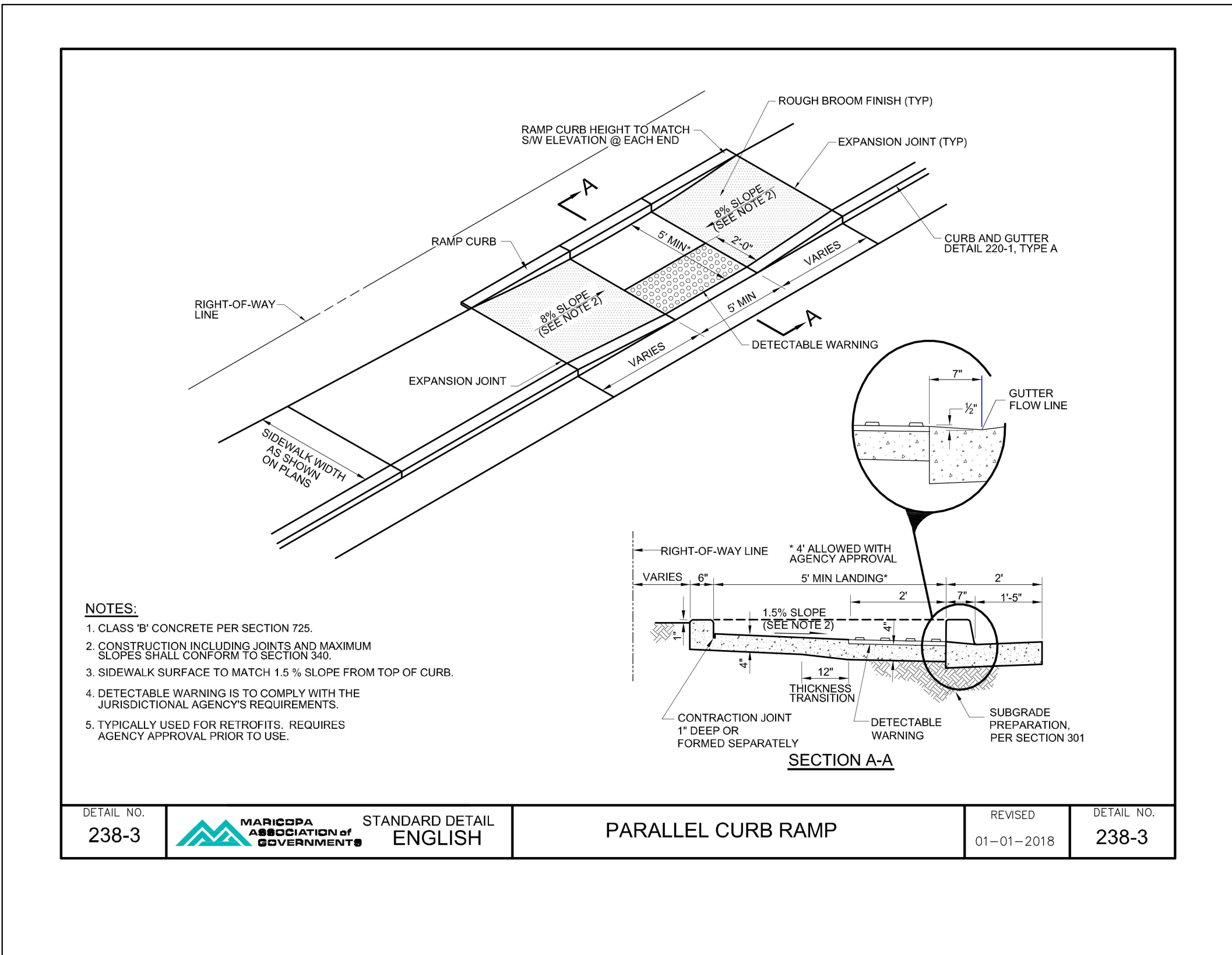

1 PARALLEL CURB RAMP - MAG STD. DTL. 238-3 N.T.S

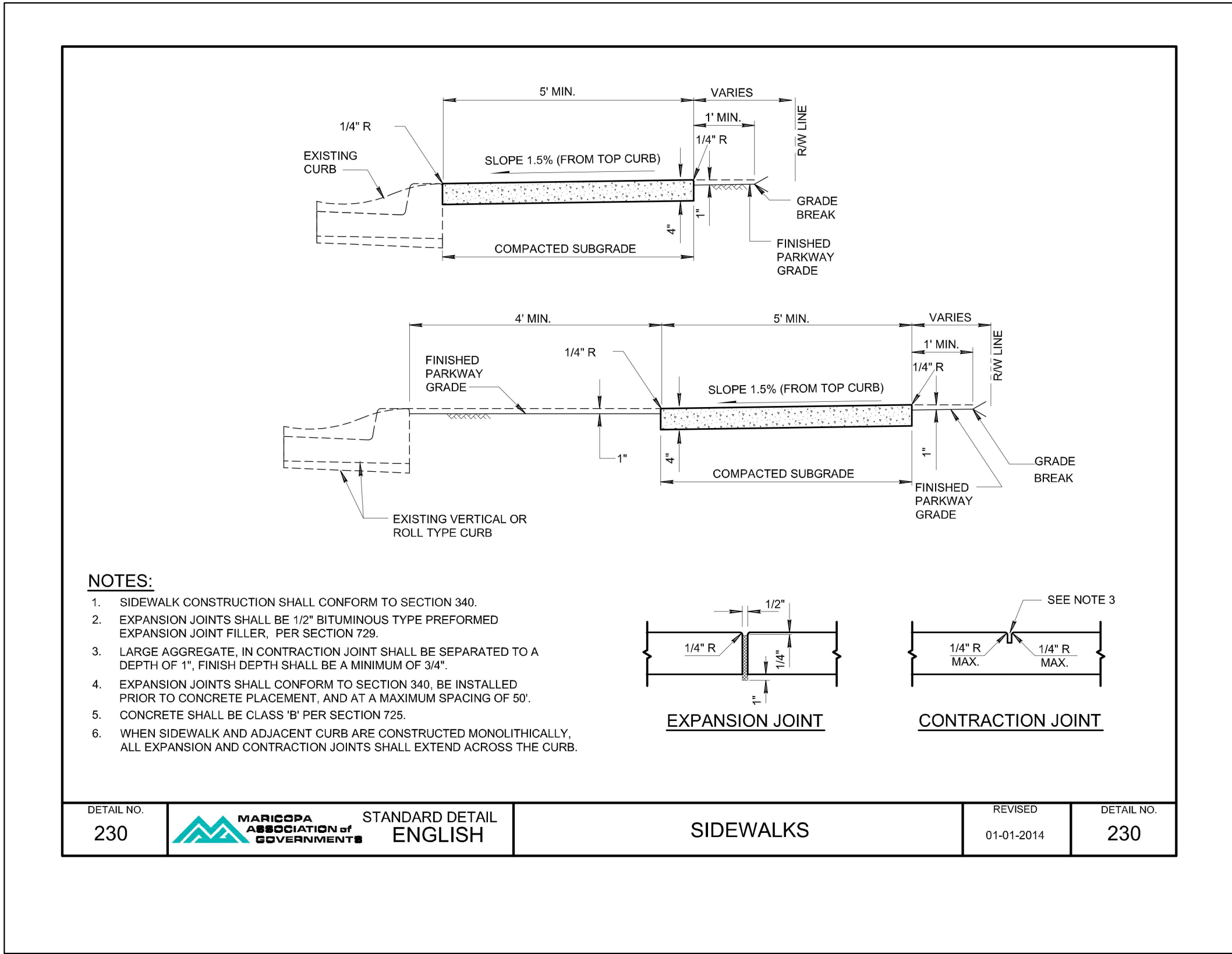

2 SIDEWALK - MAG STD. DTL. 230 MODIFIED 5-INCH THICK, 3,000 PSI N.T.S

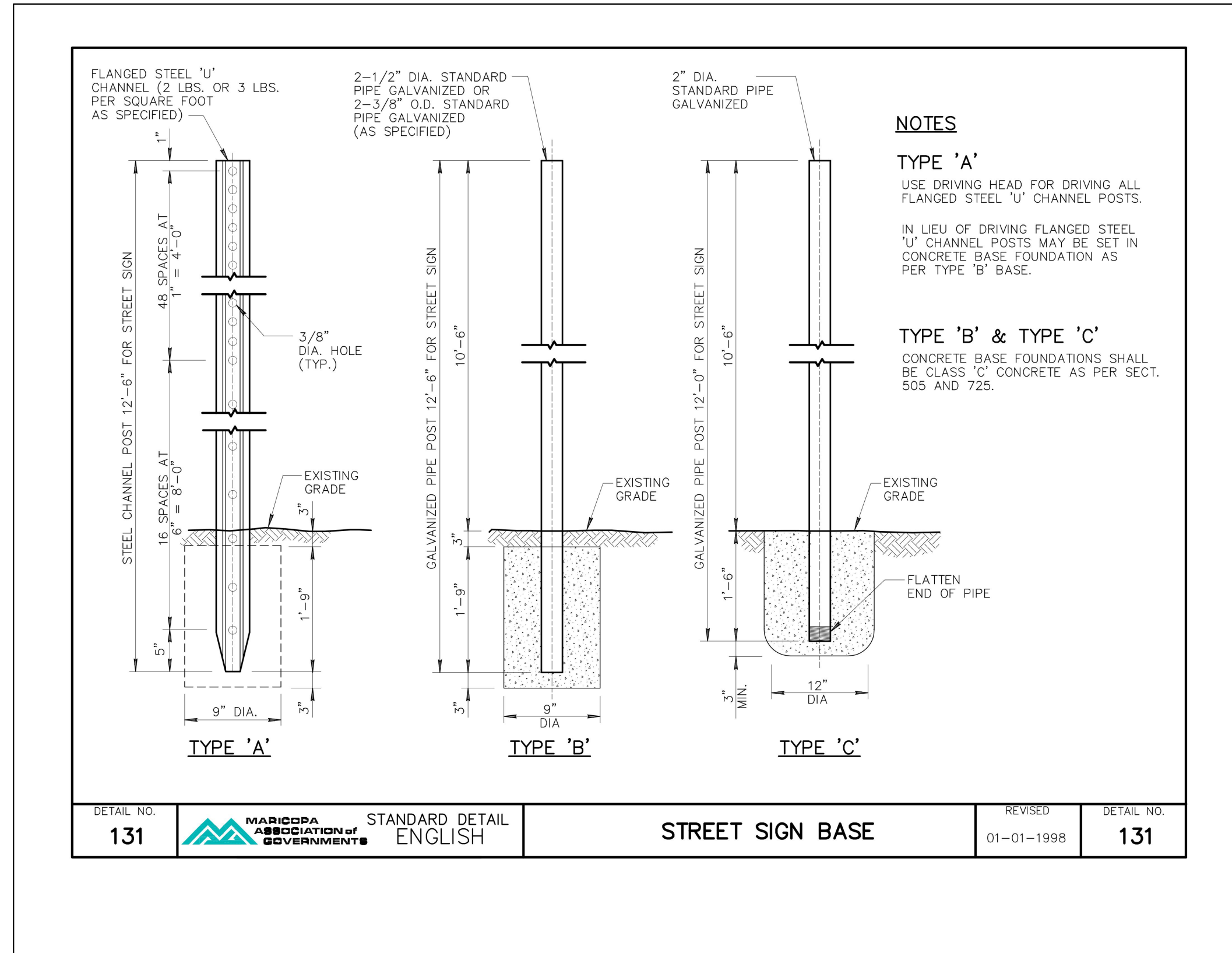

3 STREET SIGN POLE, BASE & FOUNDATION, MAG STD. DTL. 131 N.T.S

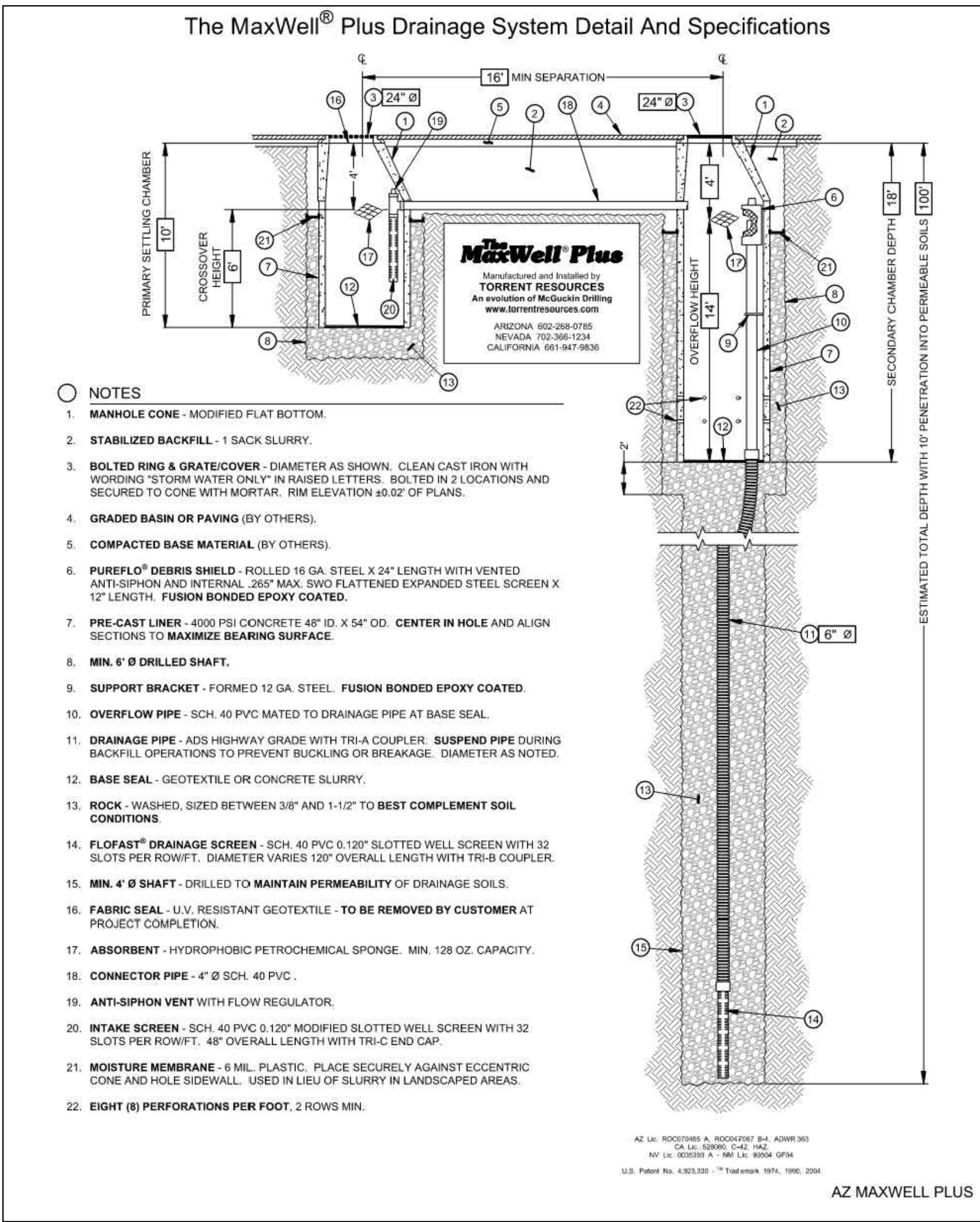

4 DRYWELL - DUAL CHAMBER N.T.S

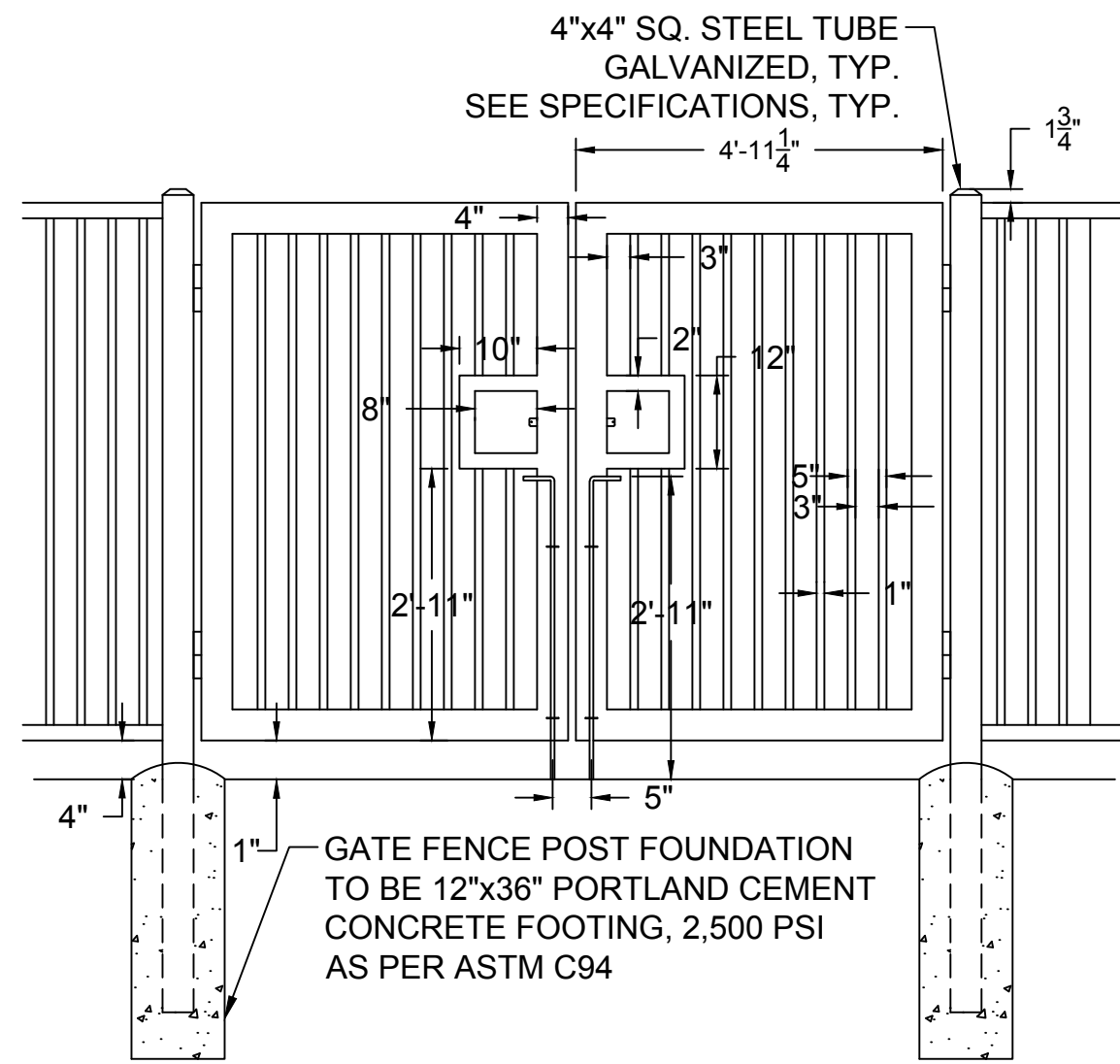

5' WIDE DOUBLE GATE - STEEL TUBE
NOT TO SCALE

1 DOUBLE WIDE MAN GATE - STEEL TUBE 5FT WIDE WITH 10 FT WIDE OPENING, 6 FT HT. N.T.S

NOTE: POWDER COAT PAINT FINISH, TYP.

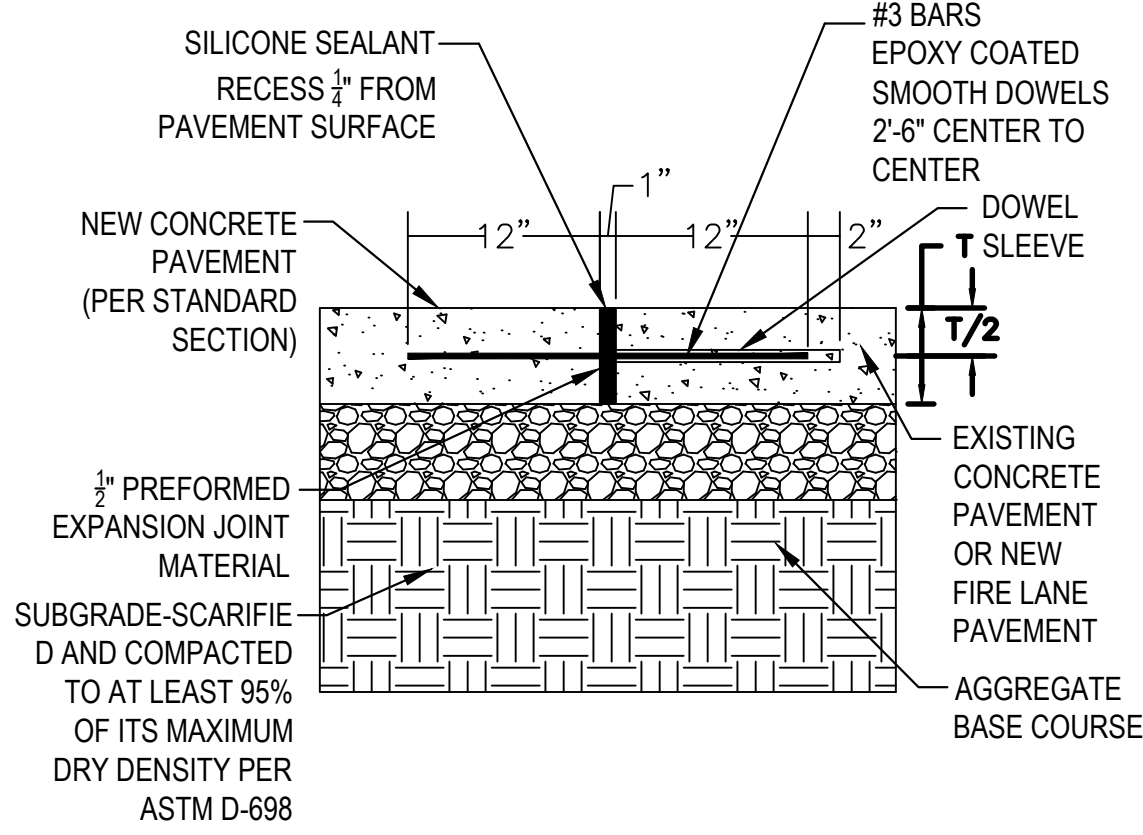

2 CONCRETE PAVEMENT DOWEL CONNECTION TO EXISTING CONCRETE PAVEMENT / SIDEWALK AND EXISTING BUILDING FOUNDATION

SCALE: N.T.S.

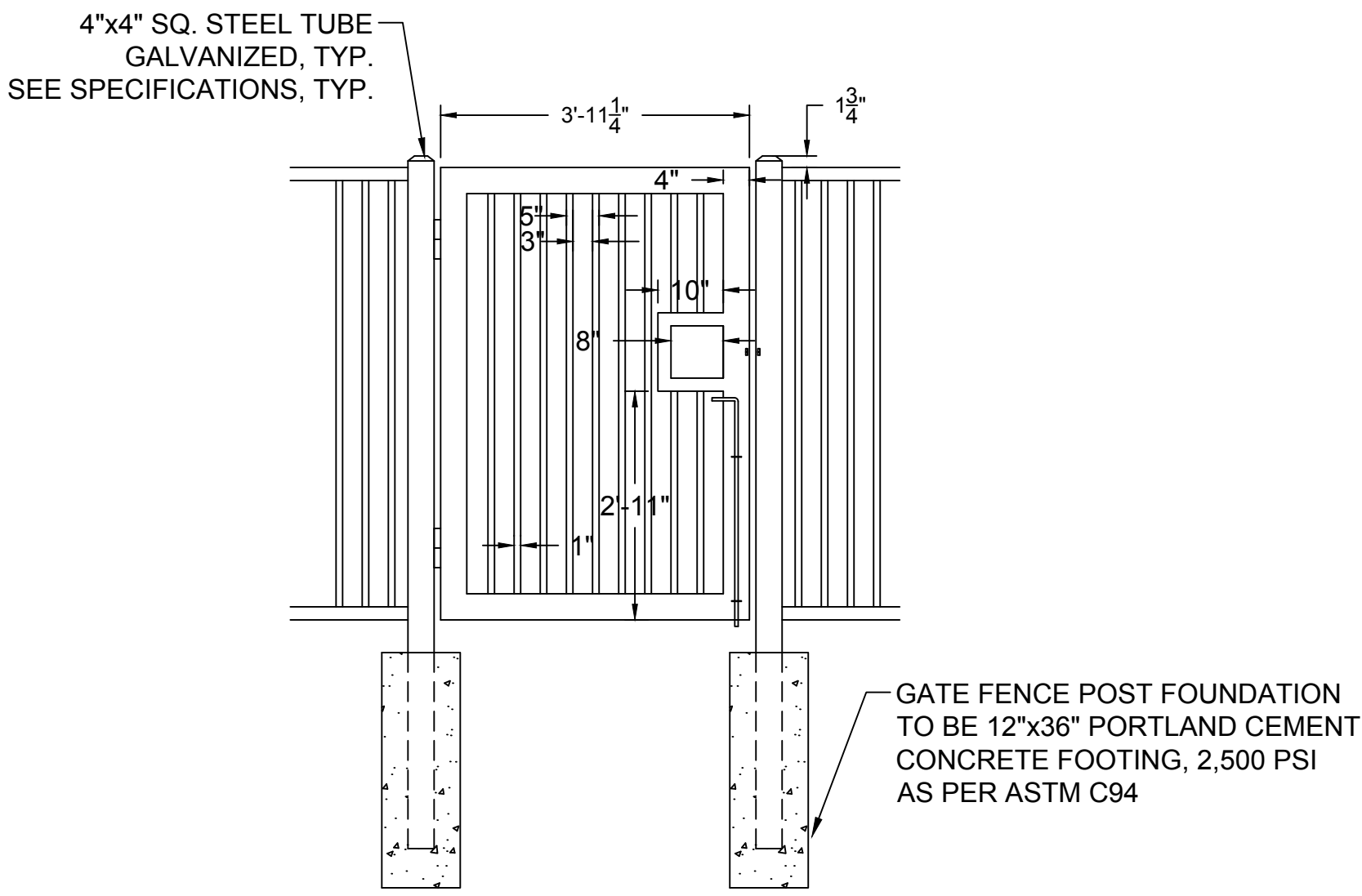

4' WIDE GATE - STEEL TUBE
NOT TO SCALE

3 SINGLE MAN GATE - STEEL TUBE 5FT WIDE WITH 10 FT WIDE OPENING, 6 FT HT. N.T.S

NOTE: POWDER COAT PAINT FINISH, TYP.

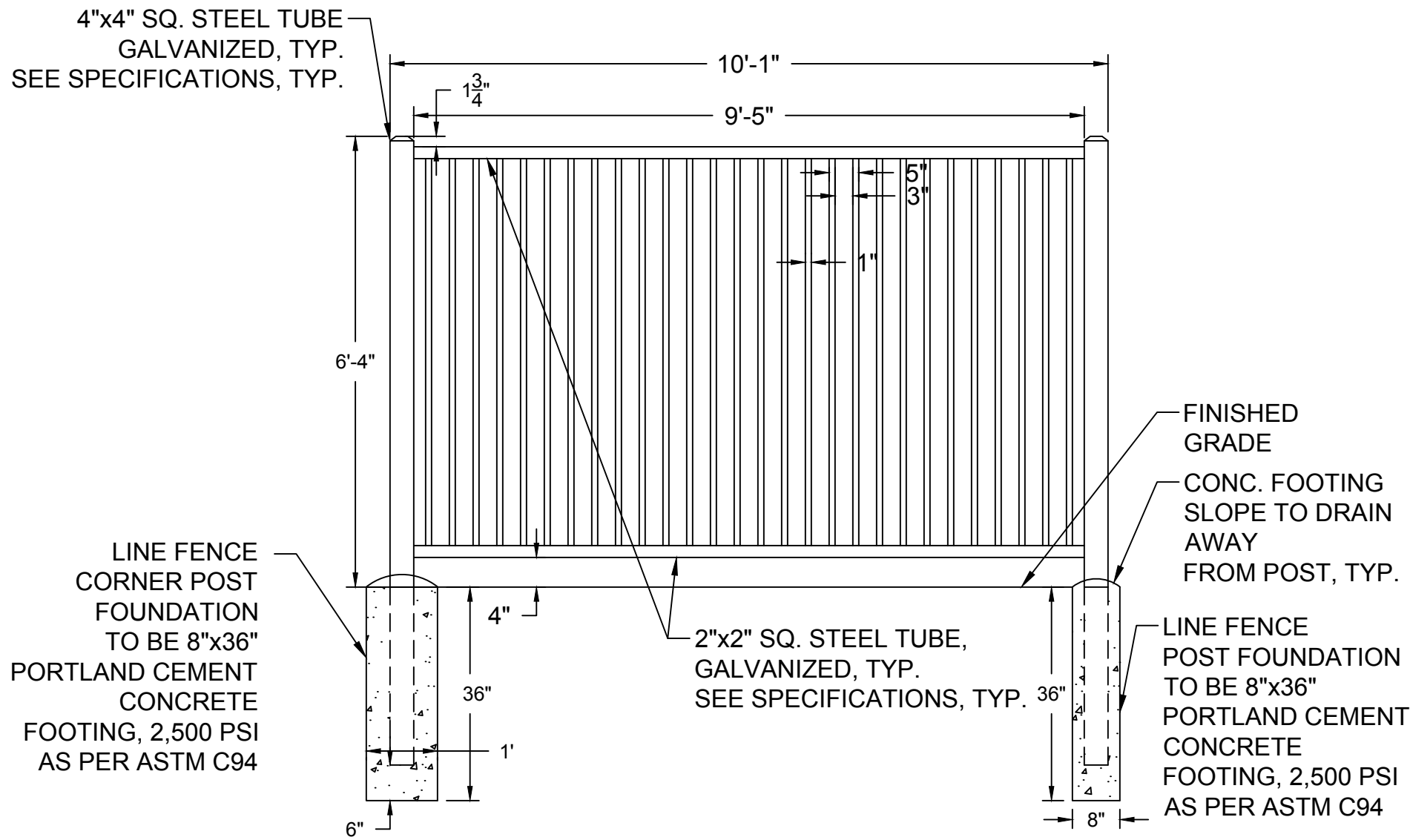

4 STEEL TUBE FENCING, 6 FT HT. N.T.S

NOTE: POWDER COAT PAINT FINISH, TYP.

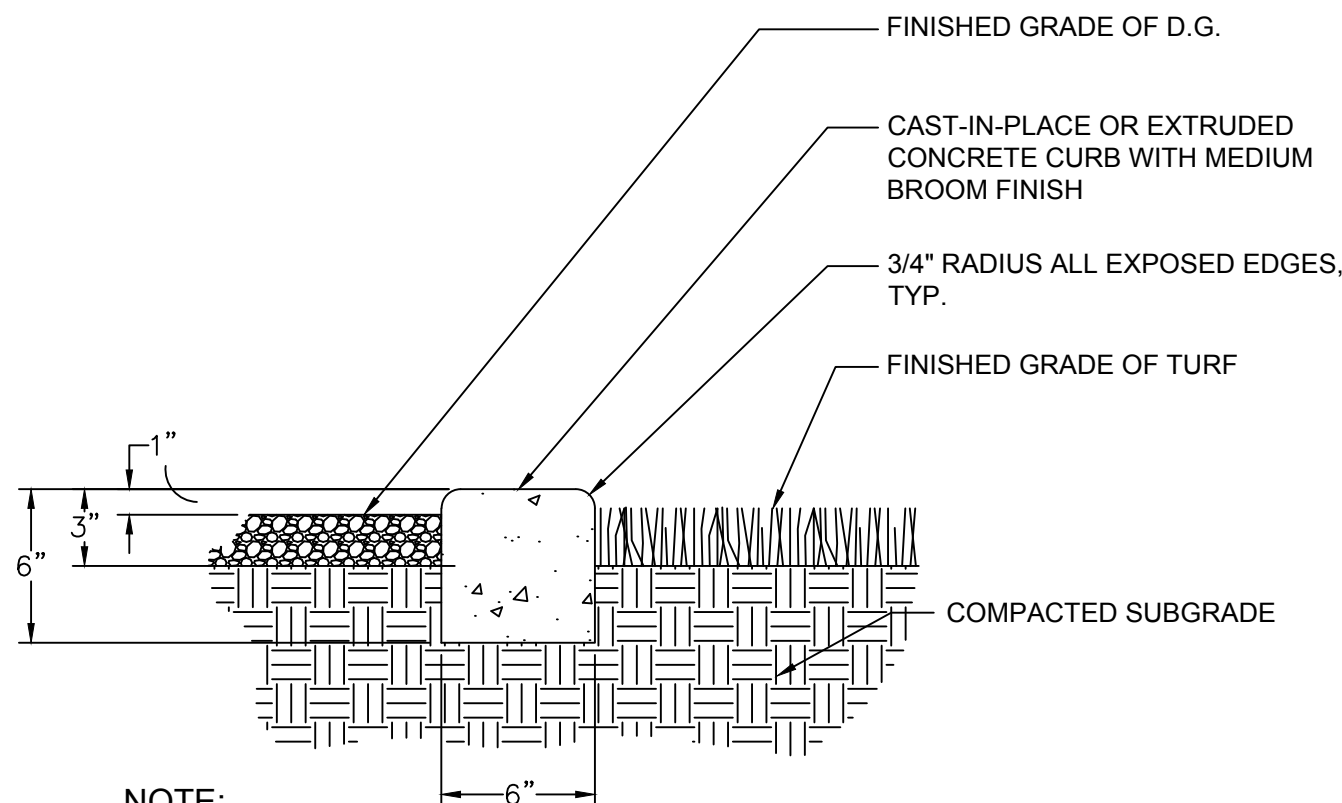

NOTE:

1. MOWSTRIP SHALL BE FLUSH WITH ADJACENT WALK/PATH, PAVEMENT OR CURB.
2. LANDSCAPE ARCHITECT SHALL APPROVE FORMWORK PRIOR TO PLACING CONCRETE IF POURED IN PLACE.
3. CONCRETE SHALL BE MAG. CLASS "B"
4. EXPANSION JOINTS @ 30'; CONTROL JOINTS 10' O.C.
5. STRAIGHT SECTIONS TO MEET CURVED SECTIONS AT TRUE TANGENT POINTS WITH NO BROKEN CURVE SECTIONS.
6. CURVED SECTIONS TO BE FORMED IN SMOOTH, EVEN CURVES AS SHOWN ON PLANS.
7. FORM STAKING SHALL NOT ALLOW DEFORMING OR LEAKING. ALL SPILL OF EXCESS CONCRETE SHALL BE CLEANED UP AND REMOVED FROM SITE BY CONTRACTOR.

6 CONCRETE HEADER AT TURF / D.G. N.T.S

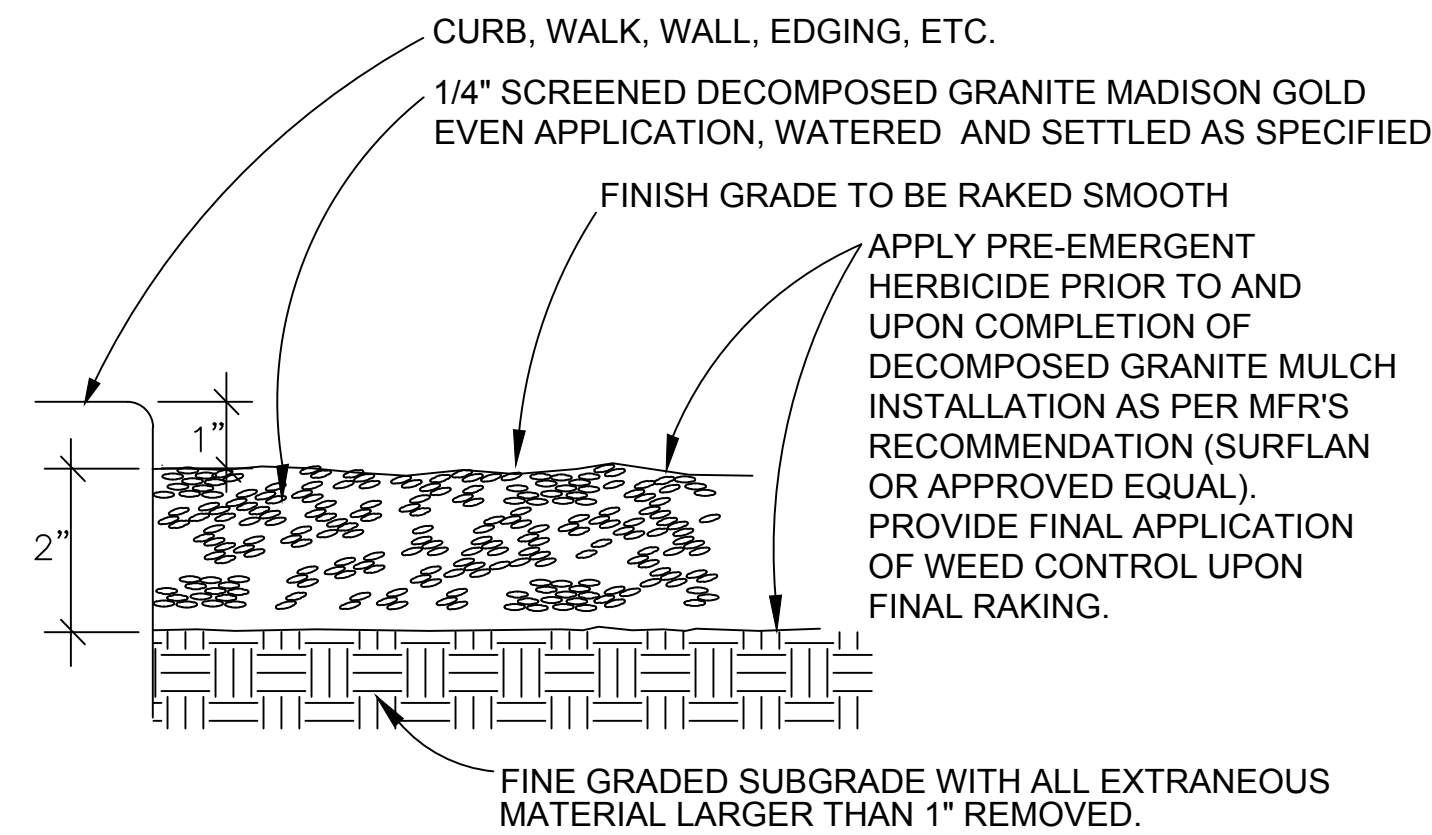

7 DECOMPOSED GRANITE PLACEMENT N.T.S

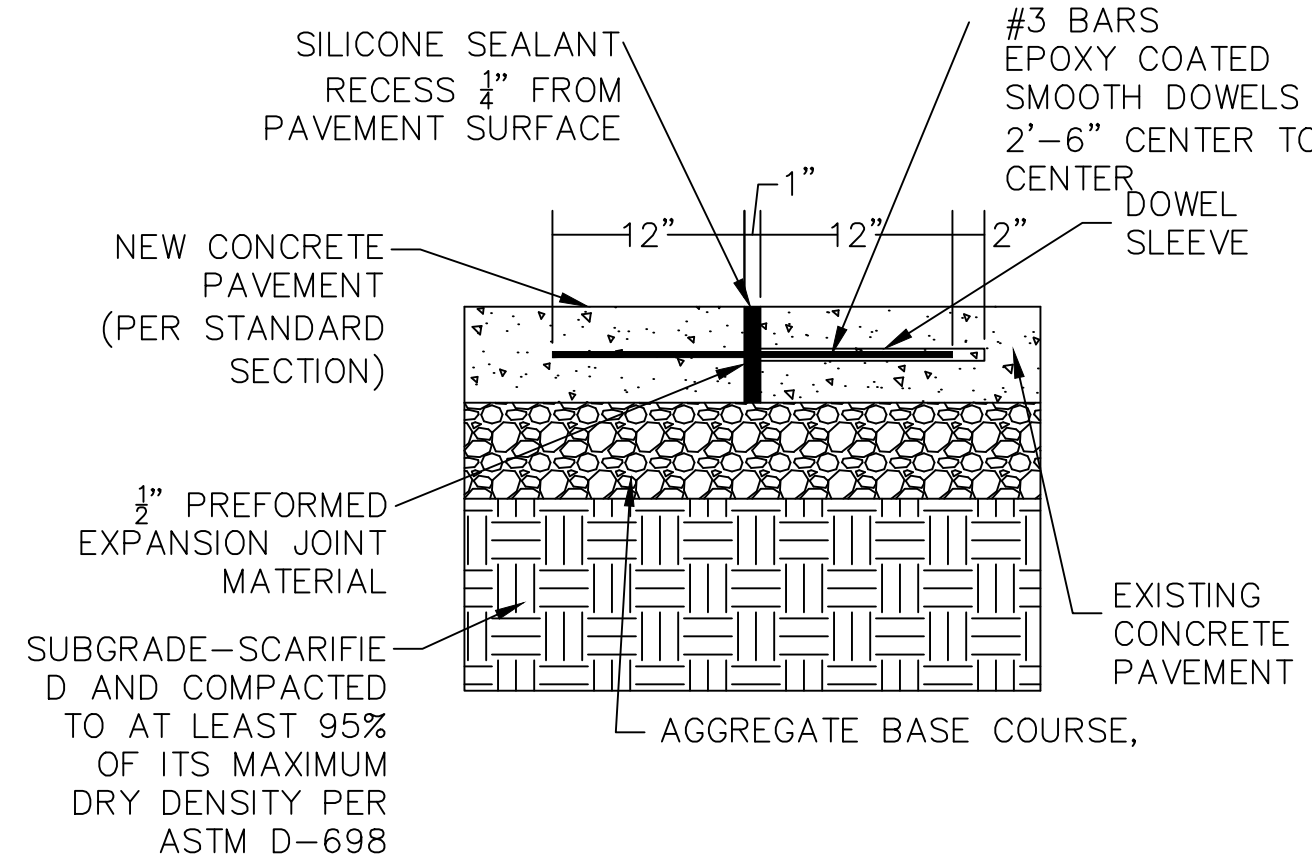

5 DOWEL CONNECT NEW CONCRETE WITH EXISTING

NOTE: POWDER COAT PAINT FINISH, TYP.



COLORS

BORDER AND TEXT:
HANDICAP SYMBOL:

GREEN
WHITE SYMBOL ON
BLUE BACKGROUND
WHITE

BACKGROUND:
DETAIL "A"
N.T.S.

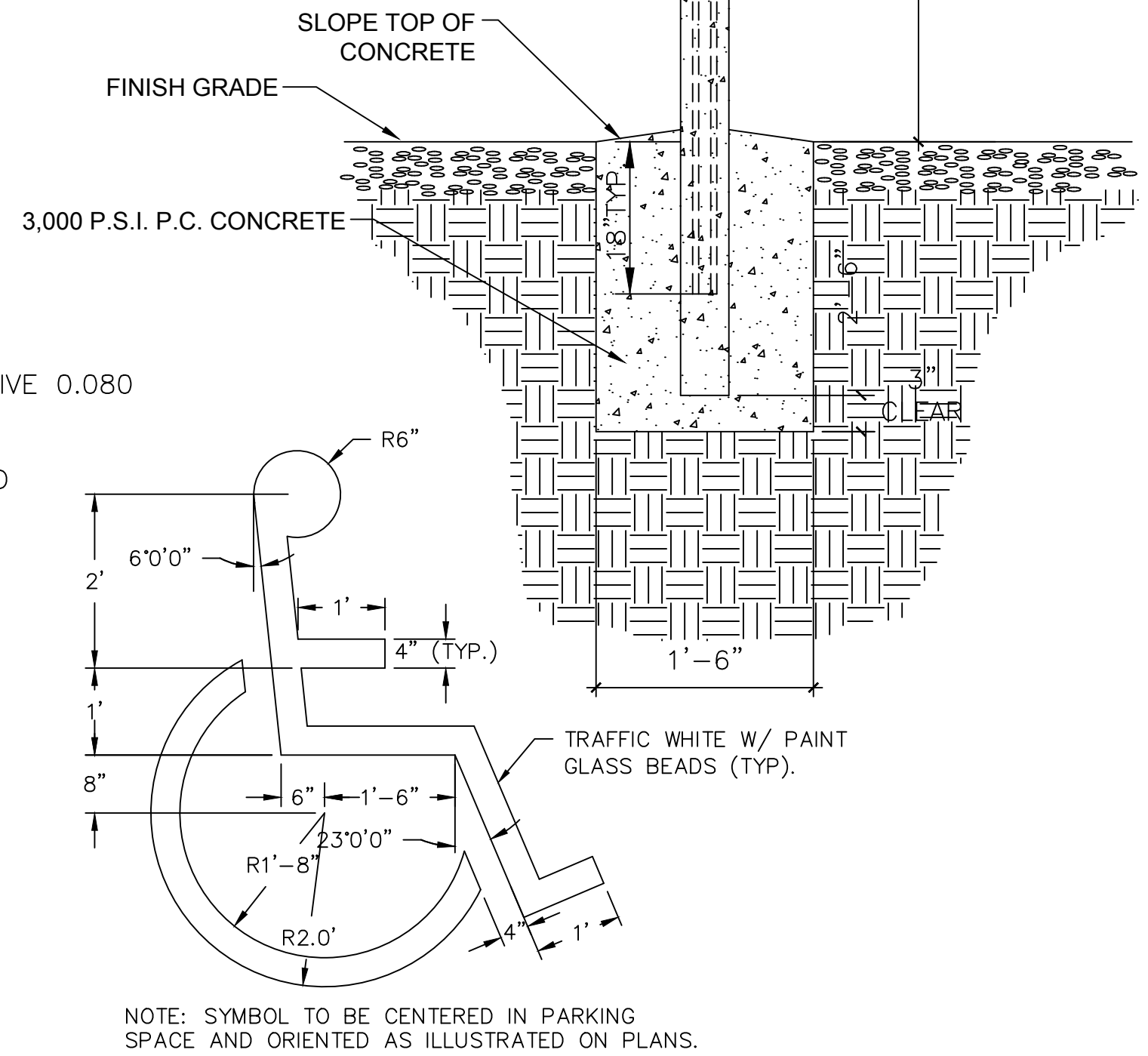

NOTE: SYMBOL TO BE CENTERED IN PARKING SPACE AND ORIENTED AS ILLUSTRATED ON PLANS.

8 ACCESSIBLE PARKING SIGN, BOLLARD, BASE AND POST N.T.S

4 BASKETBALL COURT STRIPING PLAN

NTS

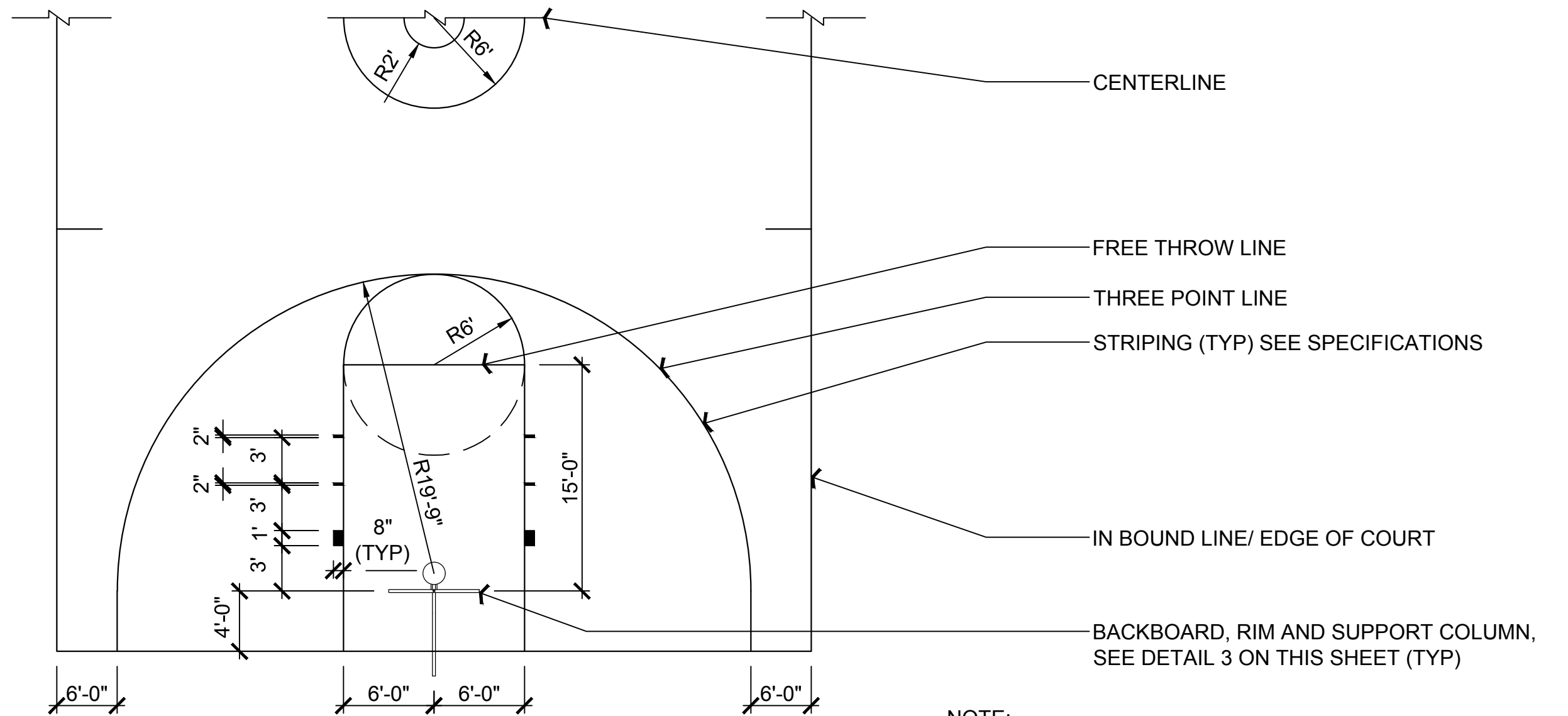

- NOTE:
1. STRIPING TO BE PAINTED AND SCORED LINES, SEE NOTES IN DETAIL 1 ON THIS SHEET (TYP)

PLAN

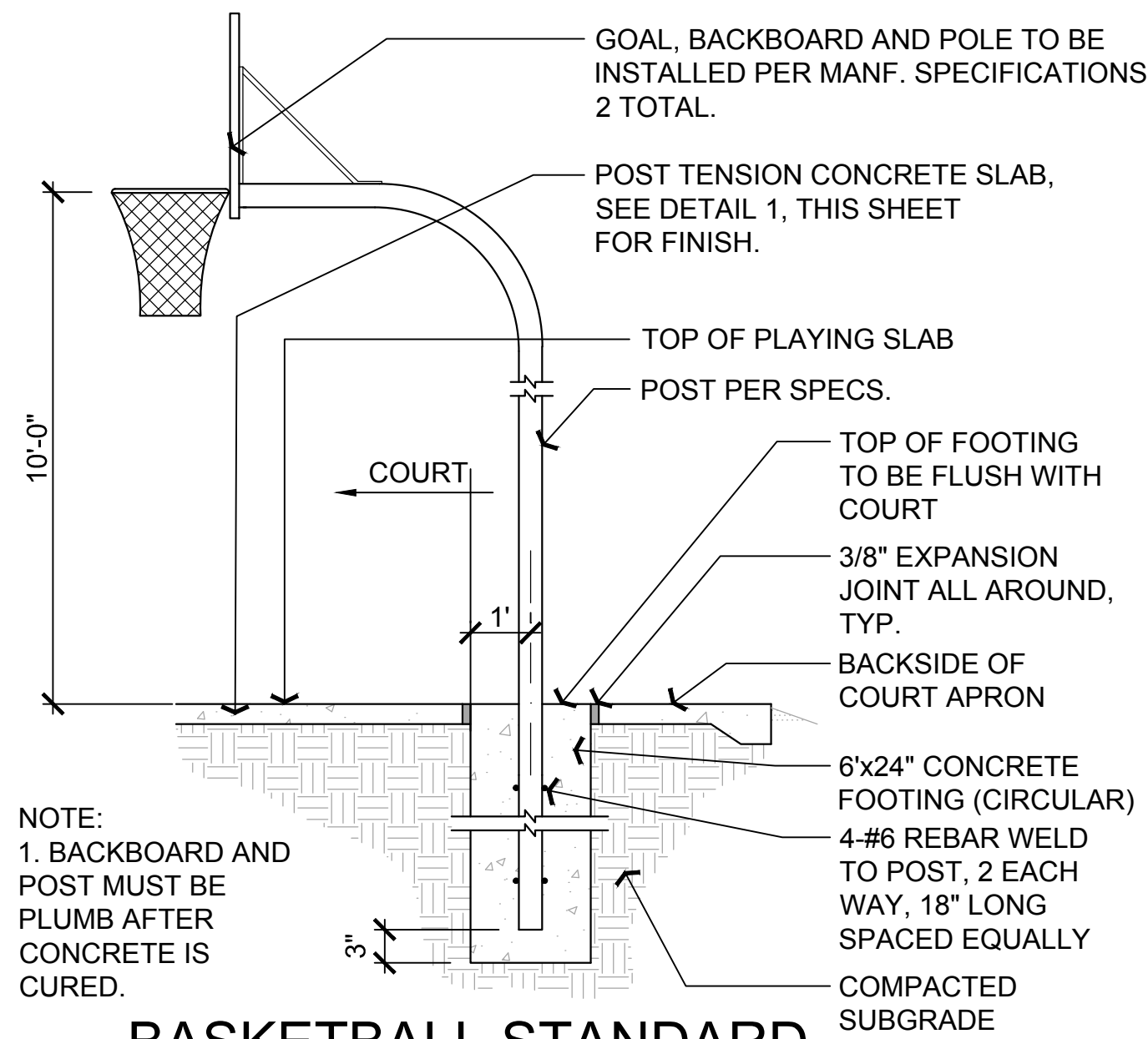

- NOTE:
1. BACKBOARD AND POST MUST BE PLUMB AFTER CONCRETE IS CURED.

3 BASKETBALL STANDARD

NTS

DETAIL

1 BASKETBALL COURT LAYOUT

NTS

PLAN

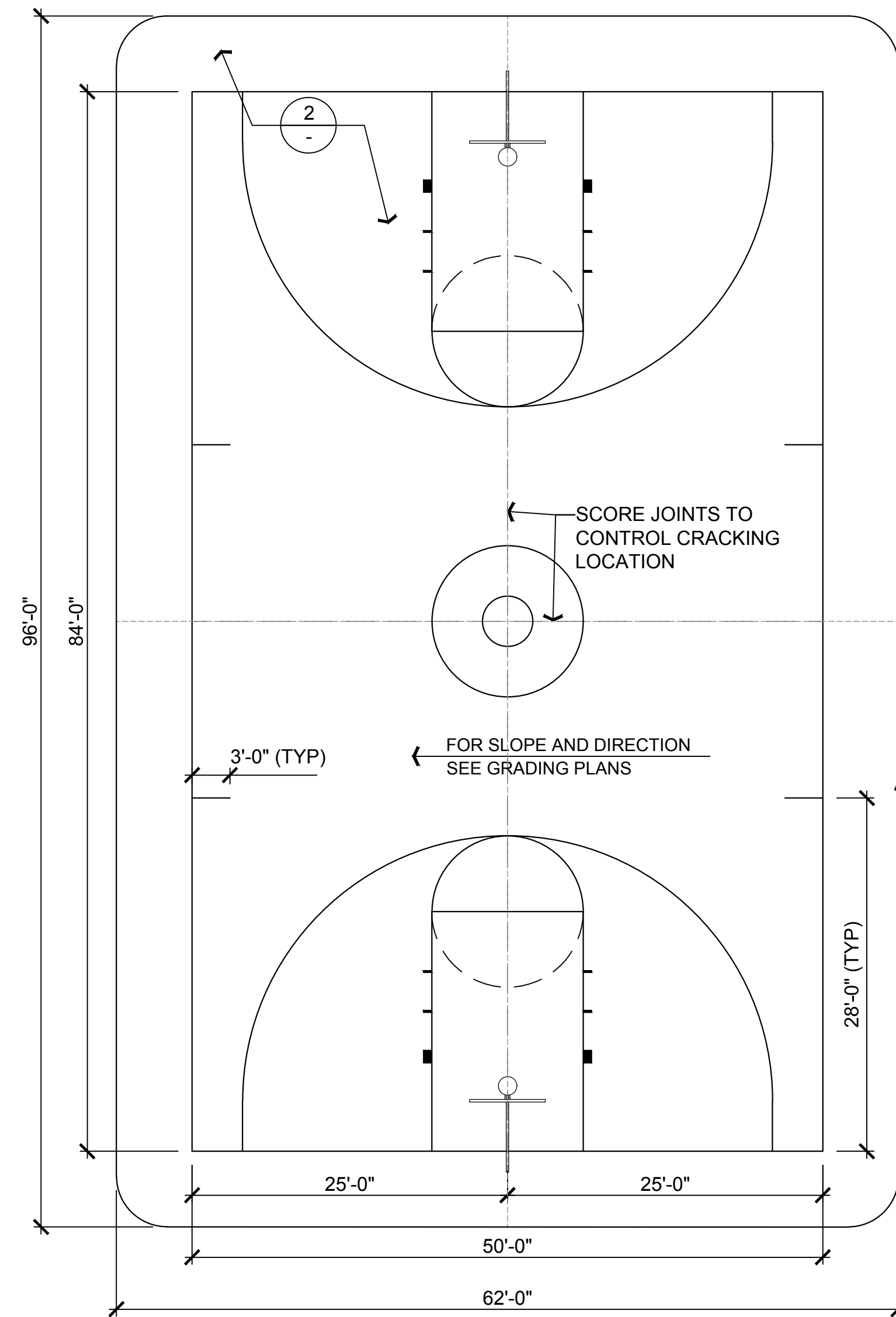

NOTES:

1. CONCRETE FINISH FOR BASKETBALL COURT TO BE LIGHT BROOM FINISH CONSISTENT THROUGHOUT COURT. HAND FINISH, NO MACHINE FINISH WILL BE ALLOWED. PROVIDE 10'X10' SAMPLE POUR FOR C.O.C. APPROVAL, PRIOR TO POURING COURT. SAMPLE PANEL SHALL NOT BE REMOVED PRIOR TO ACCEPTANCE OF ENTIRE COURT WORK BY CITY OF CHANDLER.
2. PAINT SHALL CONFORM TO SPECIFICATIONS. PROVIDE PAINT SAMPLES AND SPEC. SHEETS FOR ALL PAINT TO C.O.C. FOR APPROVAL.
3. ALL RADIUS LENGTHS ARE TO OUTSIDE OF LINE.
4. ALL STRIPING IS 2" TYP. USE WHITE PAINT OR APPROVED EQUAL FOR ALL STRIPING.
5. POST-TENSION CONCRETE SLAB DESIGN SHALL BE APPROVED PRIOR TO CONSTRUCTION VIA DEFERRED SUBMITTAL.

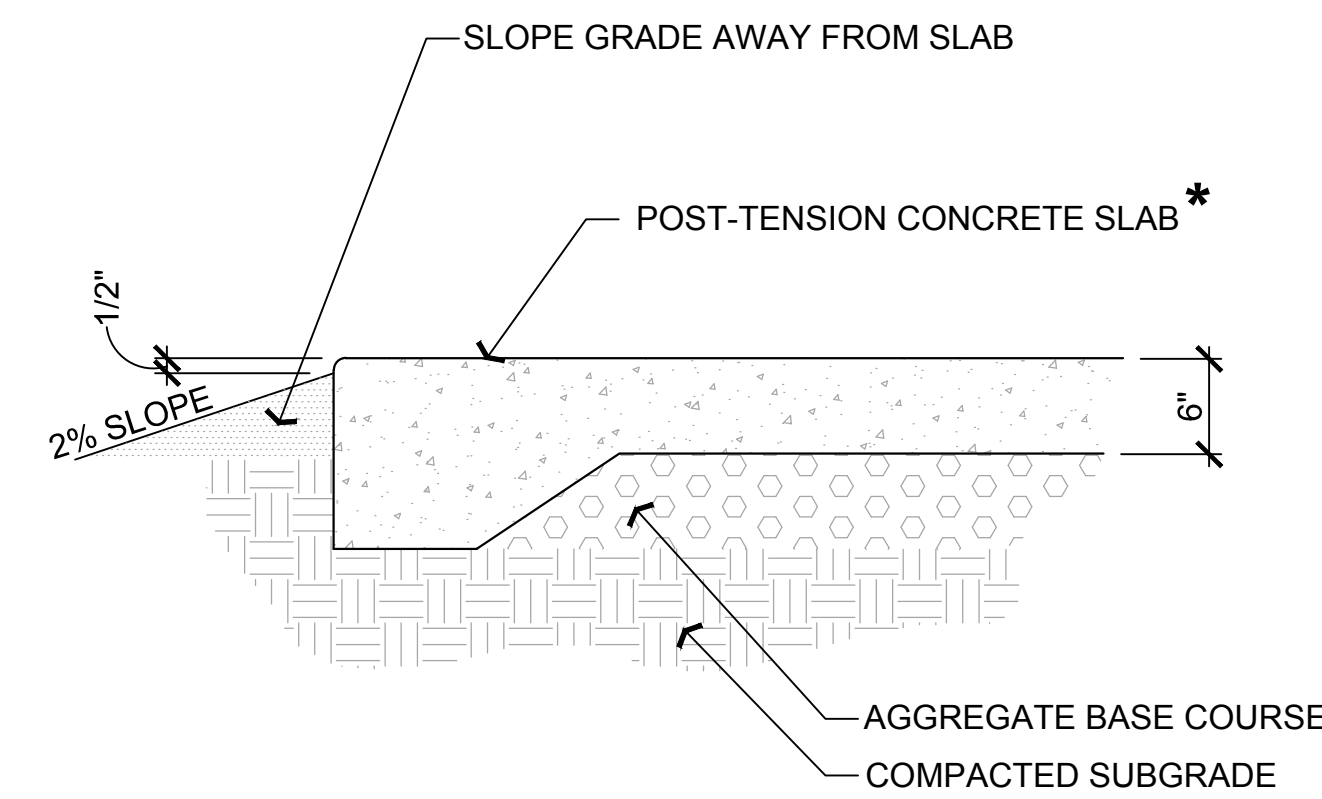

- * POST-TENSION CONCRETE SLAB DESIGN SHALL BE APPROVED PRIOR TO CONSTRUCTION VIA DEFERRED SUBMITTAL. (SEE HARDSCAPE PLAN SHEET HP1.5 FOR LIMITS OF POST TENSION SLAB)

2 POST-TENSION COURT SLAB

NTS

DETAIL

WESD - PALO VERDE MS
SITE IMPROVEMENTS
7502 N. 39th Avenue
Phoenix, AZ 85051

CONSULTANTS

CIVIL
Kirtley-Horn
7740 N. 16th St, Suite 300
Phoenix, AZ 85020
Phone: 602.944.5500

ELECTRICAL
Energy Systems Design, Inc
7135 E. Camelback Rd.
Suite 275
Scottsdale, AZ 85251
Phone: 480.481.4900

bws ARCHITECTS

BURNS WALD-HOPKINS SHAMBACH ARCHITECTS
261 North Court Avenue
Tucson, Arizona 85701
520.795.2705
www.bwsarchitects.com

DETAILS

C2.5
100% SCHEMATIC DESIGN

DRAWN BY: SRW
JOB NO: 2138.300
DATE: 11/16/23
REVISIONS